

**Industrial Ethernet  
IE-BS-V01M-LCD-SM-C**

**Weidmüller Interface GmbH & Co. KG**  
Klingenbergstraße 16  
D-32758 Detmold  
Germany  
Fon: +49 5231 14-0  
Fax: +49 5231 14-292083  
www.weidmueller.com



Bayonet plug-in connector sets according to IEC  
61076-3-106 ver.1 (EtherNet/IP), RJ45 metal insert incl.  
LC insert

**General ordering data**

Type	IE-BS-V01M-LCD-SM-C
Order No.	<a href="#">1963430000</a>
Version	Flange FO, IP 67, Version 1, LC Duplex coupling, Singlemode
GTIN (EAN)	4032248645527
Qty.	10 pc(s).

## Data sheet

### Industrial Ethernet IE-BS-V01M-LCD-SM-C

**Weidmüller Interface GmbH & Co. KG**  
 Klingenbergstraße 16  
 D-32758 Detmold  
 Germany  
 Fon: +49 5231 14-0  
 Fax: +49 5231 14-292083  
 www.weidmueller.com

## Technical data

### Dimensions and weights

Net weight 60 g

### Temperatures

Operating temperature, max.	70 °C	Operating temperature	-40 °C...70 °C
Storage temperature		Installation temperature	

### Downloads

GOST Approval POCC  
 DE.ME25.B01411.pdf

### General data

Colour	Miscellaneous	Connection 1	LC Duplex
Connection 2	LC Duplex	Description of article	Version 1, LC Duplex coupling
Fibre type	Singlemode	Housing main material	Zinc diecast
Insertion loss	≤ 0.5 dB	Plugging cycles	500
Protection degree	IP 67	Return loss (attenuation)	≥ 40 dB
Seal material	NBR		

### Standards

Connector standard IEC 61076-3-106 Var. 1,  
 IEC 61754-20

### Classifications

ETIM 3.0	EC001121	ETIM 4.0	EC000437
ETIM 5.0	EC000437	ETIM 6.0	EC000437
UNSPSC	30-21-18-17	eClass 5.1	27-26-12-03
eClass 6.2	27-26-12-03	eClass 7.1	27-25-05-04
eClass 8.1	19-17-01-25	eClass 9.0	19-17-01-25

### Approvals

Approvals



ROHS Conform

**Industrial Ethernet  
IE-BS-V01M-LCD-SM-C**

**Weidmüller Interface GmbH & Co. KG**  
Klingenbergstraße 16  
D-32758 Detmold  
Germany  
Fon: +49 5231 14-0  
Fax: +49 5231 14-292083  
www.weidmueller.com

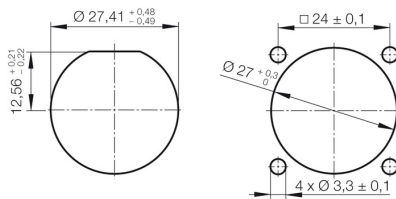
**Drawings****Installation cut-out**

Mounting cut-out: 1. With central screw connection / 2. For mounting with four M3 screws