

| | |
|----------------|---------|
| PRODUCT NUMBER | PITCH |
| V7xx72x000J0G | 5.00 mm |

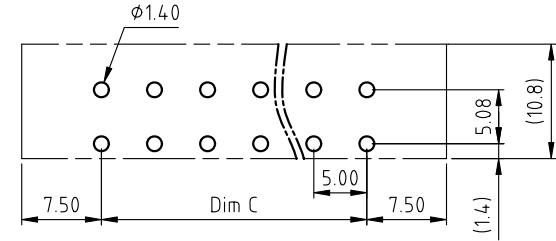

RECOMMENDED P.C.B LAYOUT
TOP VIEW

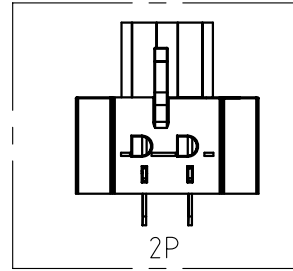
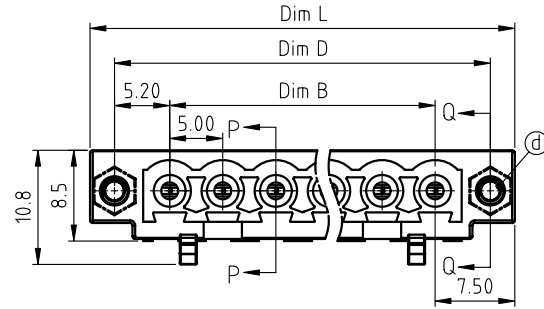
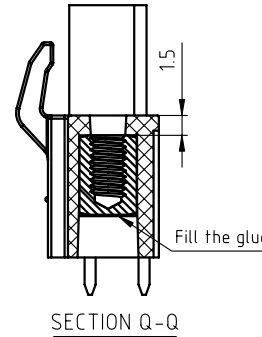
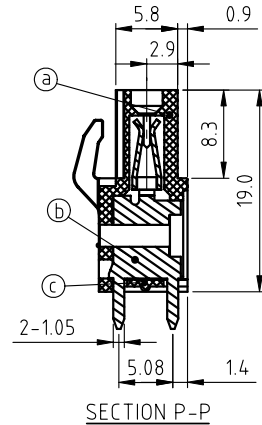
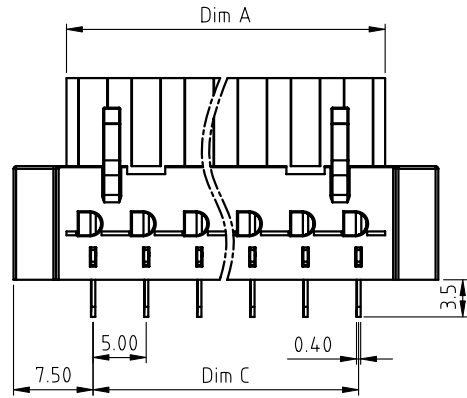

Material:

- Item ① Terminal housing: Thermoplastic (UL94V-0)
- Item ② Female contact: PhBz(CuSn), Tin plated
- Item ③ Terminal cover: Thermoplastic (UL94V-0)
- Item ④ Flange Nut: Brass M2.5

Electrical cULus

- Voltage rating: 300VAC
- Current rating: 10A
- Withstanding Voltage: 1.6kv
- Operating temperature: -40°C to +115°C
- Soldering temperature: 260°C±5°C/5 Sec
- Safety Approval:

N=Number of poles

Dim L=N×5.0+10.0

Dim A=N×5.0

Dim B=(N-1)×5.0

Dim C=(N-1)×5.0

Dim D=(N-1)×5.0+10.4

| poles | Dim L | Dim A | Dim B | Dim C | Dim D |
|--------|-------|-------|-------|-------|-------|
| 2-6p | ±0.15 | 0 | ±0.15 | ±0.15 | ±0.15 |
| 7-12p | ±0.20 | -0.20 | ±0.20 | ±0.20 | ±0.20 |
| 13-18p | ±0.30 | 0 | ±0.30 | ±0.30 | ±0.30 |
| 19-24p | ±0.40 | -0.30 | ±0.40 | ±0.40 | ±0.40 |

PART NO.: V7 xx 7 2 x 0 00J0 G

| | Solid block | No. of poles | Color | RoHS compliant (lead<4%) In copper Alloy |
|-----|-----------------|--------------|-------------------|---|
| 0 | Black (RAL9005) | 2 | Red (RAL3001/D) | |
| 02 | 2poles | 3 | Orange(RAL2011/P) | |
| 03 | 3poles | 4 | Yellow(RAL1018/A) | |
| ... | ... | 5 | Green(RAL6018/T) | |
| 24 | 24poles | 6 | Blue (RAL5015/A) | |
| | | 8 | Grey(RAL7035/D) | |
| | | 9 | White(RAL1102) | |
| | | C | Green(RAL6018/U) | |

| | | | | | |
|---------------------------------------|----------------|-----------------------|-------------------------|--------------------------|---|
| mat'l. code | | surface ASME Y14.5 | tolerance ASME Y14.5 | projection | product family TERMINAL BLOCK |
| ltr | ecn no | dr | date | | title TERMINAL BLOCK |
| tolerances unless otherwise specified | | | | | |
| angles | | X.±0.5 | | scale | PLUGGABLE PCB PLUG, WITH FLANGE, VERTICAL |
| X*±1° | | X.XX±0.3 | | | |
| dr | | EVIN ZHONG | 043014 | | dwg no V7xx72x000J0G |
| enrg | | EVIN ZHONG | 043014 | | |
| chr | | HANKE FENG | 043014 | | |
| appd | | SHI JUN | 043014 | | |
| sheet index | revision sheet | A | 1 | type CUSTOMER Drawing | |