

DO NOT SCALE FROM THIS PRINT

THIS PRODUCT MANUFACTURED WITH LEAD-FREE PROCESSING

DESIGNED & DIMENSIONED IN MILLIMETERS [INCHES]

MMCX-P-C-X-RA-CA1



PLATING SPECIFICATION
 -H: 30μ" GOLD CENTER CONTACT,
 3μ" GOLD OUTER CONTACT
 (SEE TABLE 1)

TABLE 1		
ITEM	COMPONENT	-H
1	SUB ASSEMBLY	SUB-MMCX-P-C-HF-RA-CA1
2	FERRULE	MCX-FER-002-F
3	INSULATOR	MMCX-INS-001
4	CAP	MMCX-CAP-001-F

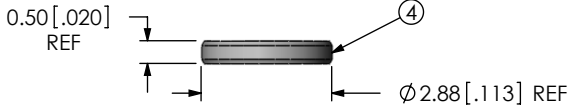
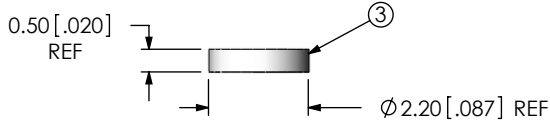
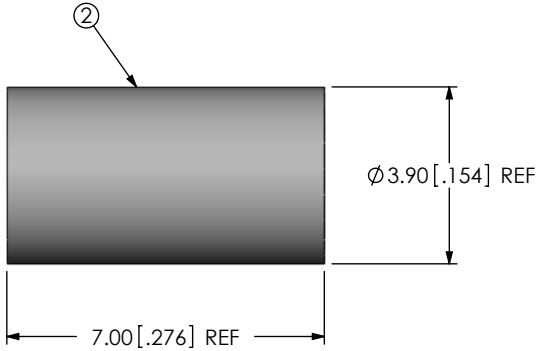
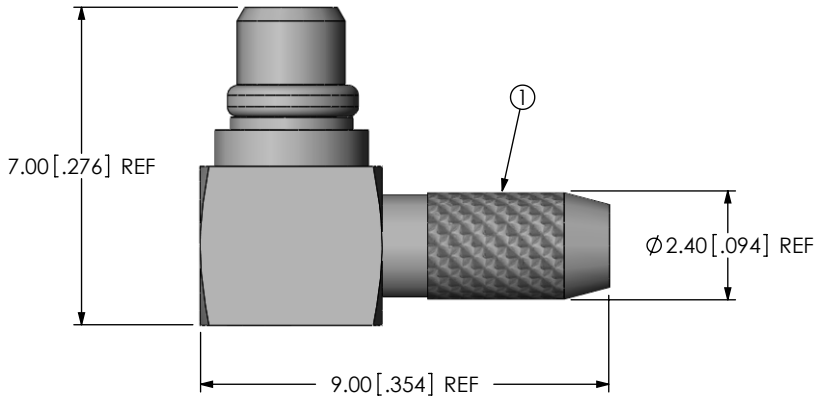

- NOTES:
- ① REPRESENTS A CRITICAL DIMENSION.
 - CENTER CONTACT PUSHOUT FORCE: 26.69 N [6LB] MIN
 - NOTE DELETED.
 - NOTE DELETED.
 - PRODUCT TO BE PACKAGED PER PACKAGING STANDARD CO-HD-WI-3040-M.
 - NOTE DELETED.
 - NOTE DELETED.
 - NOTE DELETED.

F:\DWG\MISC\MKTG\MMCX-P-C-X-RA-CA1-MKT.SLDDRW

UNLESS OTHERWISE SPECIFIED, DIMENSIONS ARE IN MILLIMETERS [INCHES]. TOLERANCES ARE:
 DECIMALS ANGLES
 .X: ±0.3 [.01] 5°
 .XX: ±0.13 [.005]
 .XXX: ±0.051 [.0020]

PROPRIETARY NOTE
 THIS DOCUMENT CONTAINS INFORMATION CONFIDENTIAL AND PROPRIETARY TO SAMTEC, INC. AND SHALL NOT BE REPRODUCED OR TRANSFERRED TO OTHER DOCUMENTS OR DISCLOSED TO OTHERS OR USED FOR ANY PURPOSE OTHER THAN THAT WHICH IT WAS OBTAINED WITHOUT THE EXPRESSED WRITTEN CONSENT OF SAMTEC, INC.



520 PARK EAST BLVD, NEW ALBANY, IN 47150
 PHONE: 812-944-6733 FAX: 812-948-5047
 e-Mail info@SAMTEC.com code 55322

MATERIAL: DO NOT SCALE DRAWING SHEET SCALE: 6:1
 SHELL, FERRULE, CAP: BRASS
 CONTACT: BRASS
 DIELECTRIC: PTFE

DESCRIPTION:
 MMCX R/A CABLE PLUG, RG174 & RG316- 50 OHM

DWG. NO.
MMCX-P-C-X-RA-CA1

BY: R MUSSER 02/06/2008 SHEET 1 OF 2



1.50±0.30 [.059±.012]



2.70±0.30 [.106±.012]



7.60±0.30 [.299±.012]

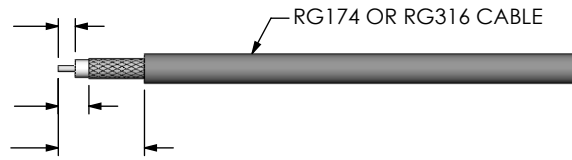

IN-PROCESS 1
STRIP AND TIN INNER CONDUCTOR

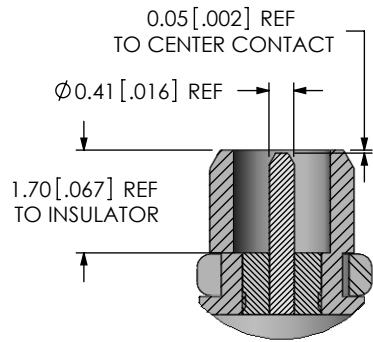

DETAIL 'A'
SCALE 8:1

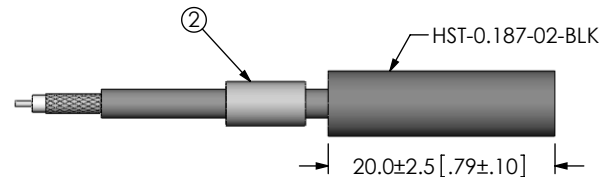

IN-PROCESS 2
ADD HEAT SHRINK TUBE AND FERRULE

Ø2.40 [.094]
(MIN. FLARED ID)

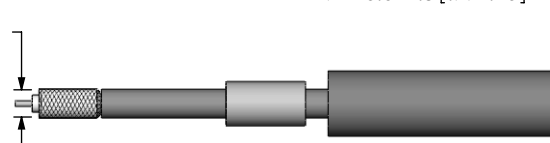

IN-PROCESS 3
FLARE SHIELD

END OF CABLE DIELECTRIC
SHOULD NOT SEAT AGAINST
CONTACT CUP

CABLE CENTER CONDUCTOR
SHOULD NOT PROTRUDE
OUTSIDE CONTACT CUP AFTER
FERRULE IS CRIMPED

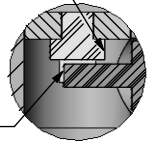

DETAIL 'C'

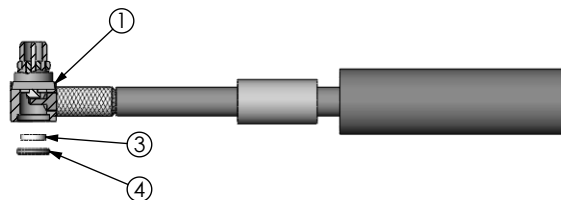

IN-PROCESS 4
ADD SUB ASSEMBLY

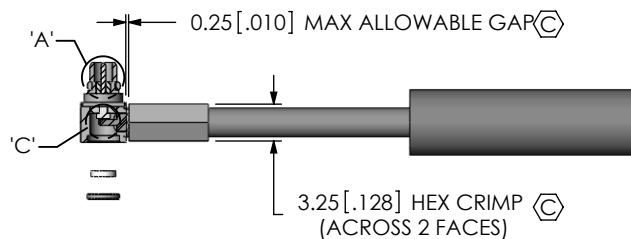

IN-PROCESS 5
CRIMP FERRULE & SOLDER SIGNAL PIN
(USE RF CRIMP HAND TOOL # CAT-HT-126667-21)

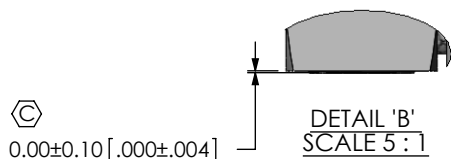

DETAIL 'B'
SCALE 5:1

IN-PROCESS 6
INSERT INSULATOR AND CAP



0.6 [.03] MAX GAP ALLOWABLE



IN-PROCESS 7
APPLY HEAT SHRINK TUBING

F:\DWG\MISC\MKTG\MMCX-P-C-X-RA-CA1-MKT.SLDRW

PROPRIETARY NOTE

THIS DOCUMENT CONTAINS INFORMATION
CONFIDENTIAL AND PROPRIETARY TO
SAMTEC, INC. AND SHALL NOT BE REPRODUCED
OR TRANSFERRED TO OTHER DOCUMENTS OR
DISCLOSED TO OTHERS OR USED FOR ANY
PURPOSE OTHER THAN THAT WHICH IT WAS
OBTAINED WITHOUT THE EXPRESSED WRITTEN
CONSENT OF SAMTEC, INC.

DO NOT SCALE DRAWING

SHEET SCALE: 6:1



520 PARK EAST BLVD, NEW ALBANY, IN 47150
PHONE: 812-944-6733 FAX: 812-948-5047
e-Mail: info@SAMTEC.com code 55322

DESCRIPTION:
MMCX R/A CABLE PLUG, RG174 & RG316- 50 OHM

DWG. NO.
MMCX-P-C-X-RA-CA1

BY: R MUSSER 02/06/2008 SHEET 2 OF 2