

| LOC |     | DIST                      |         | REVISIONS |      |  |  |
|-----|-----|---------------------------|---------|-----------|------|--|--|
| P   | LTR | DESCRIPTION               | DATE    | DWN       | APVD |  |  |
| C   |     | REVISED PER ECR-09-023963 | 11NOV09 | HMR       | KR   |  |  |

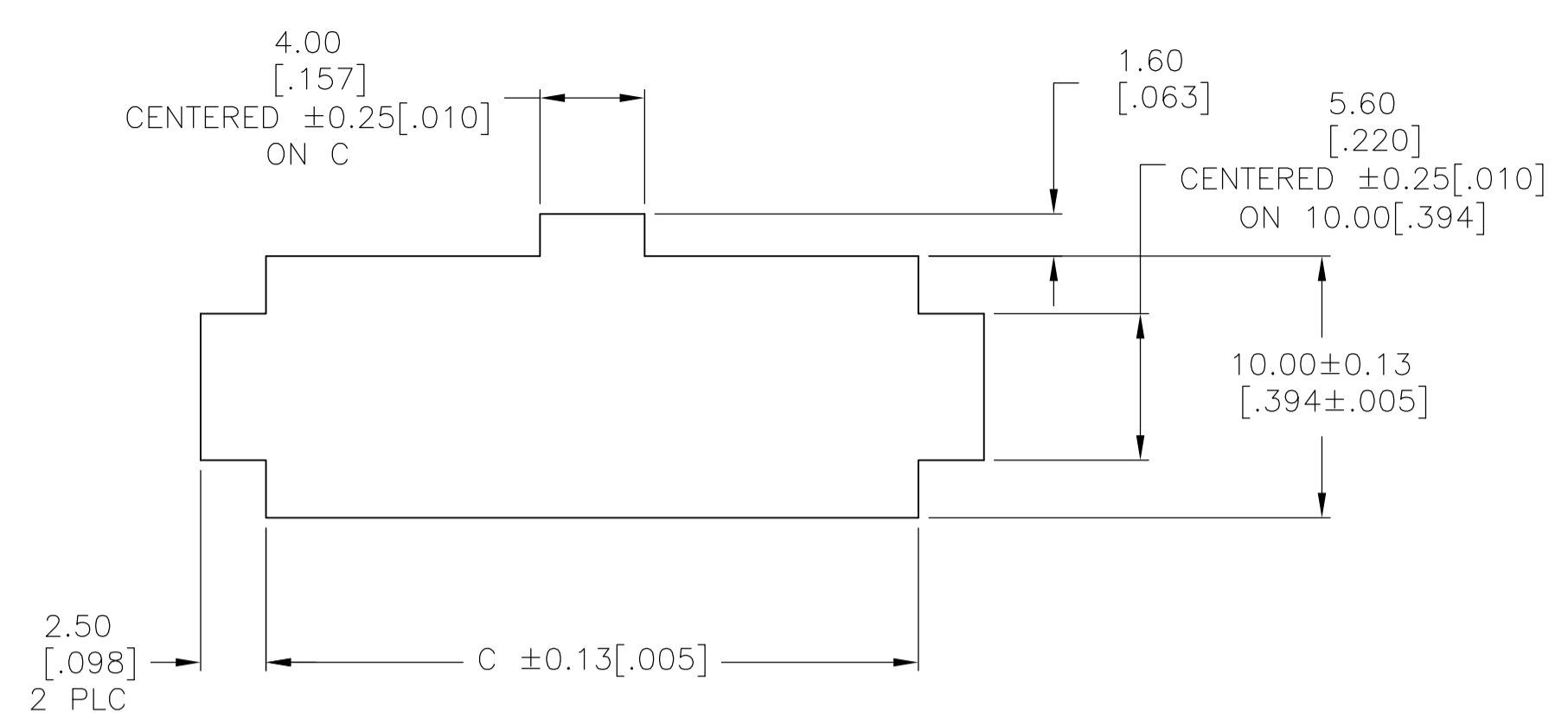

RECOMMENDED CUT OUT FOR  
 2.00 [.079] MAX THICK PANEL

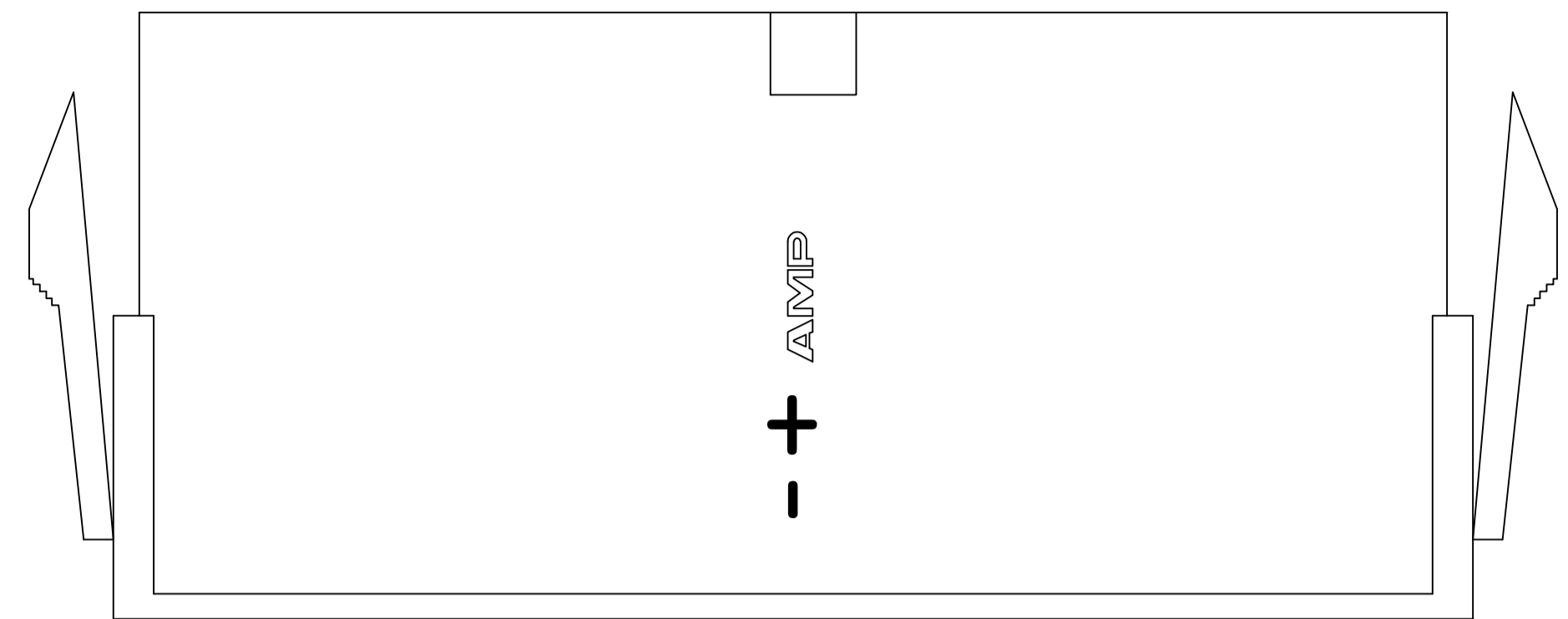
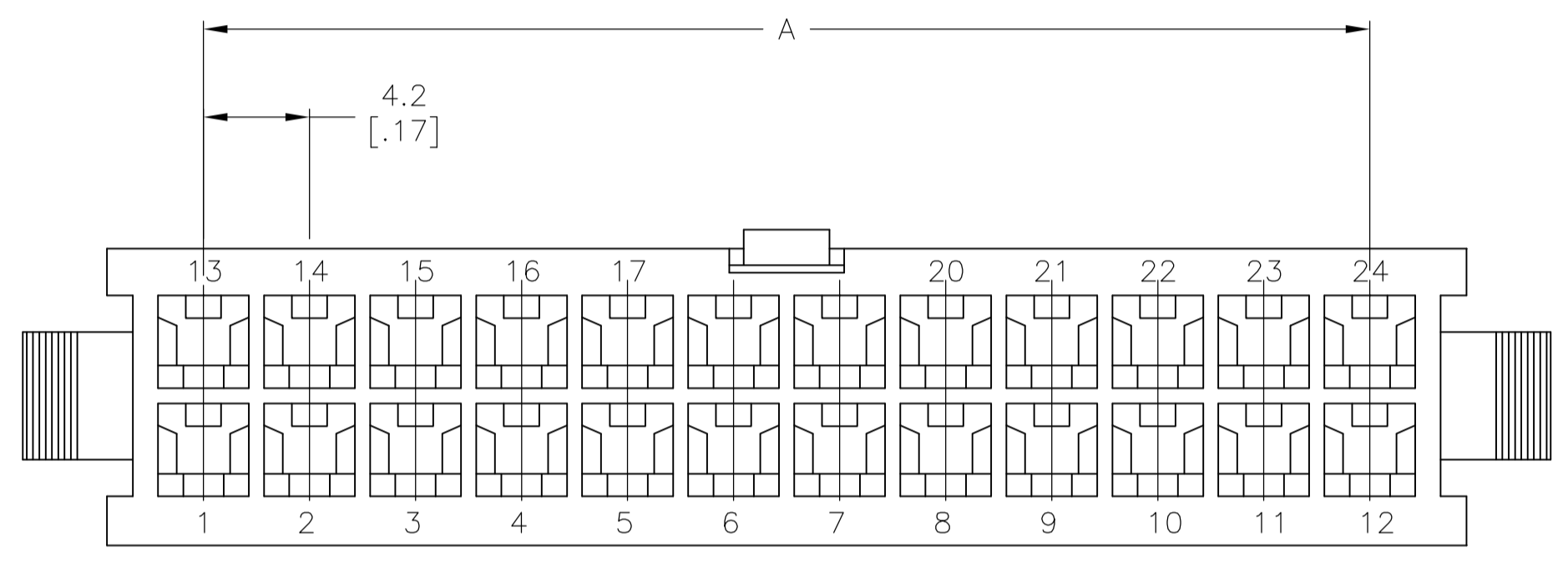

- 1 NYLON, UL94V-0, BLACK.
- 2 PANEL MUST BE PUNCHED SO THAT THE HOUSING ENTERS THE PANEL IN THE SAME DIRECTION AS THE PUNCH.

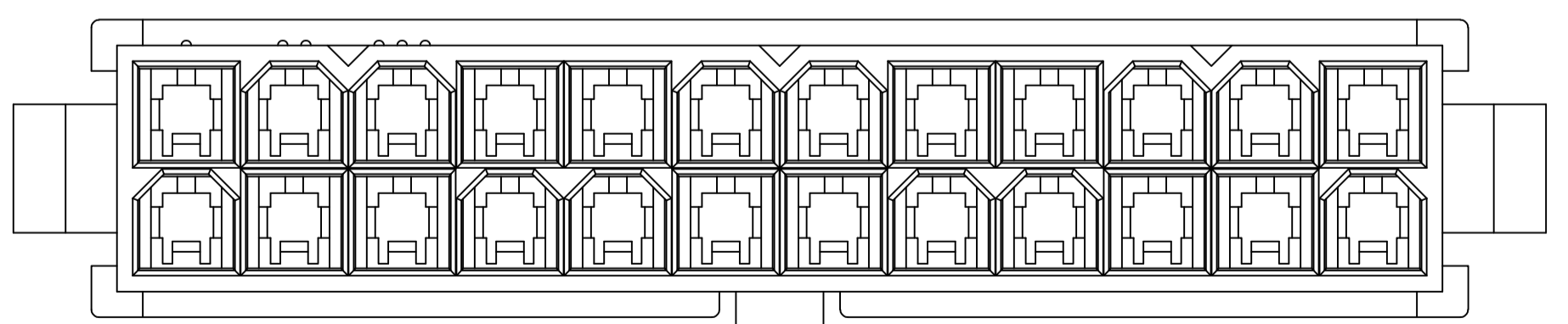
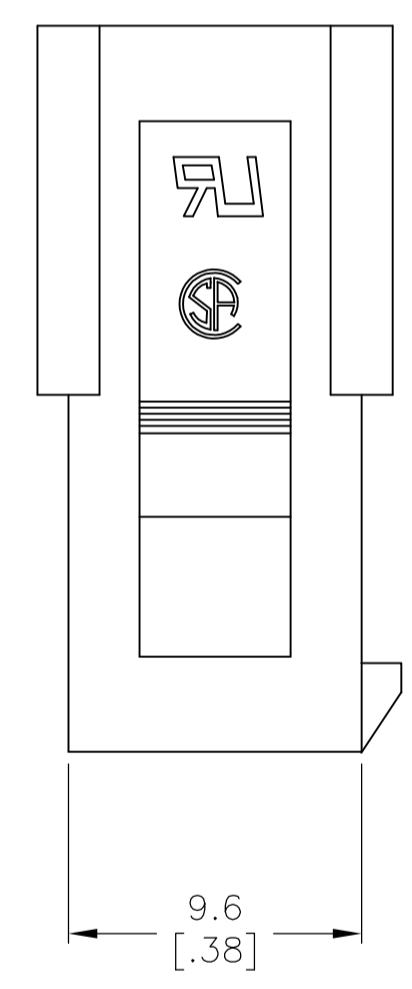
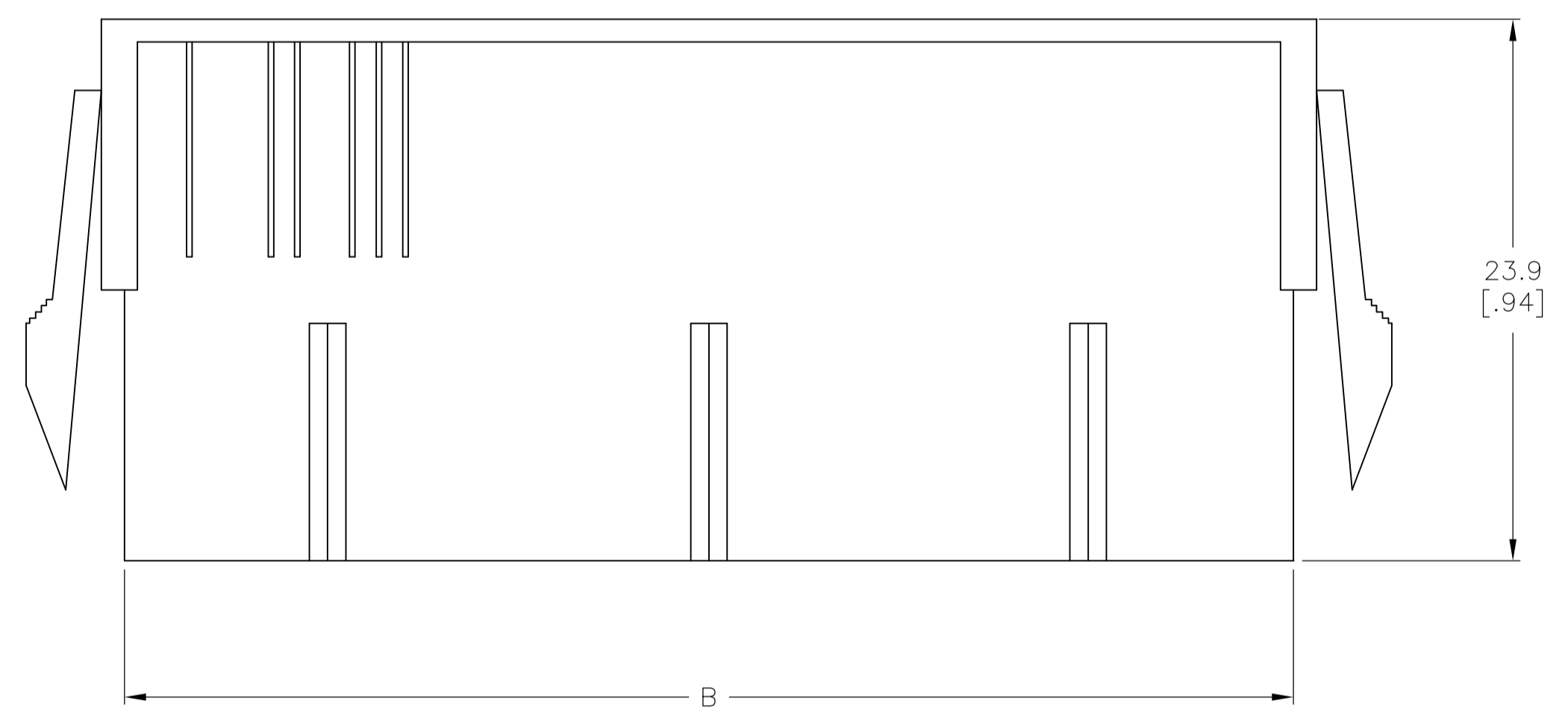
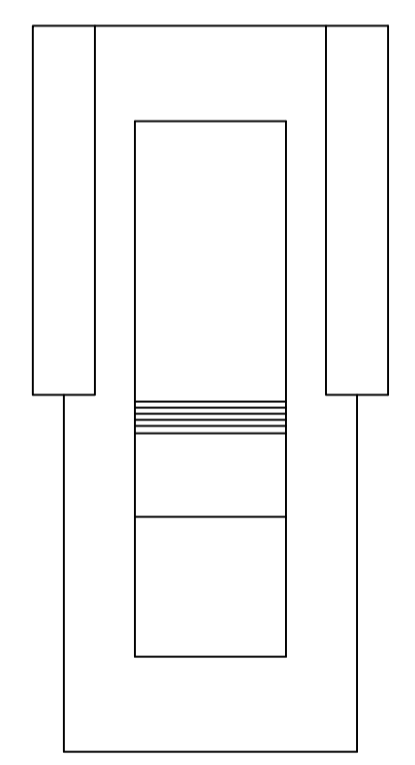

| 52.00[2.047] | 51.60[2.031] | 46.2[1.82] | 24  | 2-2029035-4 |
|--------------|--------------|------------|-----|-------------|
| 47.80[1.882] | 47.40[1.866] | 42.0[1.65] | 22  | 2-2029035-2 |
| 43.60[1.717] | 43.20[1.701] | 37.8[1.49] | 20  | 2-2029035-0 |
| 39.40[1.551] | 39.00[1.535] | 33.6[1.32] | 18  | 1-2029035-8 |
| 35.20[1.386] | 34.80[1.370] | 29.4[1.16] | 16  | 1-2029035-6 |
| 31.00[1.220] | 30.60[1.205] | 25.2[.99]  | 14  | 1-2029035-4 |
| 26.80[1.055] | 26.40[1.039] | 21.0[.83]  | 12  | 1-2029035-2 |
| 22.60[.889]  | 22.20[.874]  | 16.8[.66]  | 10  | 1-2029035-0 |
| 18.40[.724]  | 18.00[.709]  | 12.6[.50]  | 8   | 2029035-8   |
| 14.20[.559]  | 13.80[.543]  | 8.4[.33]   | 6   | 2029035-6   |
| 10.00[.394]  | 9.60[.378]   | 4.2[.17]   | 4   | 2029035-4   |
| 5.80[.223]   | 5.40[.213]   | --         | 2   | 2029035-2   |
| DIM C        | DIM B        | DIM A      | POS | PART NUMBER |

THIS DRAWING IS A CONTROLLED DOCUMENT.

|                         |  |                           |   |
|-------------------------|--|---------------------------|---|
| DIMENSIONS: mm [INCHES] | TOLERANCES UNLESS OTHERWISE SPECIFIED: | DWN K. WHITAKER 05FEB2008 | Tyco Electronics Corporation<br>Harrisburg, PA 17105-3608 |
| 0 PLC ±                 | 1 PLC ± 0.4 [.02]                      | CHK C. CASH 05FEB2008     |   |
| 2 PLC ± 0.25 [.010]     | 3 PLC ± 0.150 [.0059]                  | APVD C. CASH 05FEB2008    | Tyco Electronics<br>NAME                                  |
| 4 PLC ±                 | ANGLES ±                               | PRODUCT SPEC              |   |
| MATERIAL                | FINISH                                 | APPLICATION SPEC          | PANEL MOUNT PLUG HOUSING,<br>BLACK, VAL-U-LOK(TM)         |
|                         |  | WEIGHT                    |   |
|                         |  | SIZE                      | RESTRICTED TO   |
|                         |  | SCALE 4:1                 | REV C   |

00779 C=2029035

