

THIS DRAWING IS UNPUBLISHED. RELEASED FOR PUBLICATION
 © COPYRIGHT - By - ALL RIGHTS RESERVED.

LOC		DIST		REVISIONS					
AD		39		P	LTR	DESCRIPTION	DATE	DWN	APVD
				J2		REVISED PER ECO-11-004917	11MAR11	RK	HMR

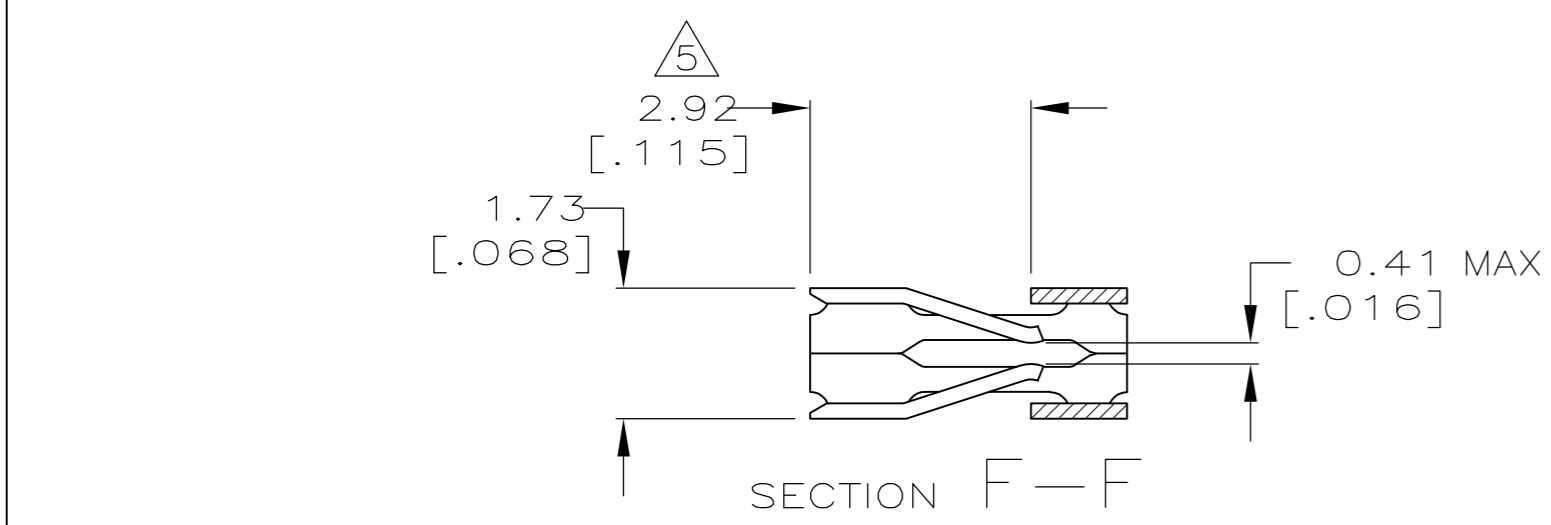
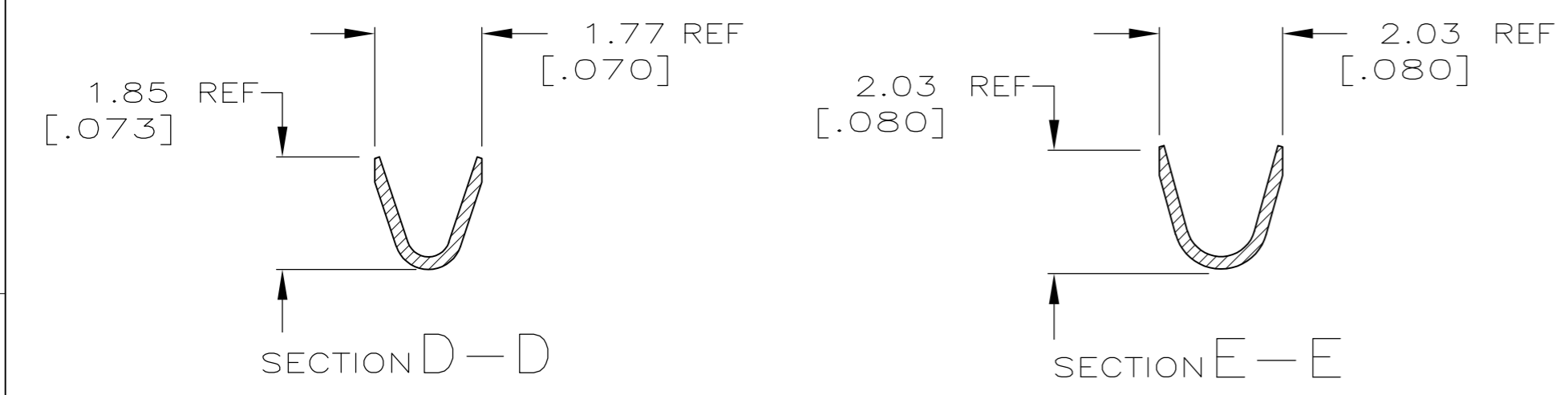
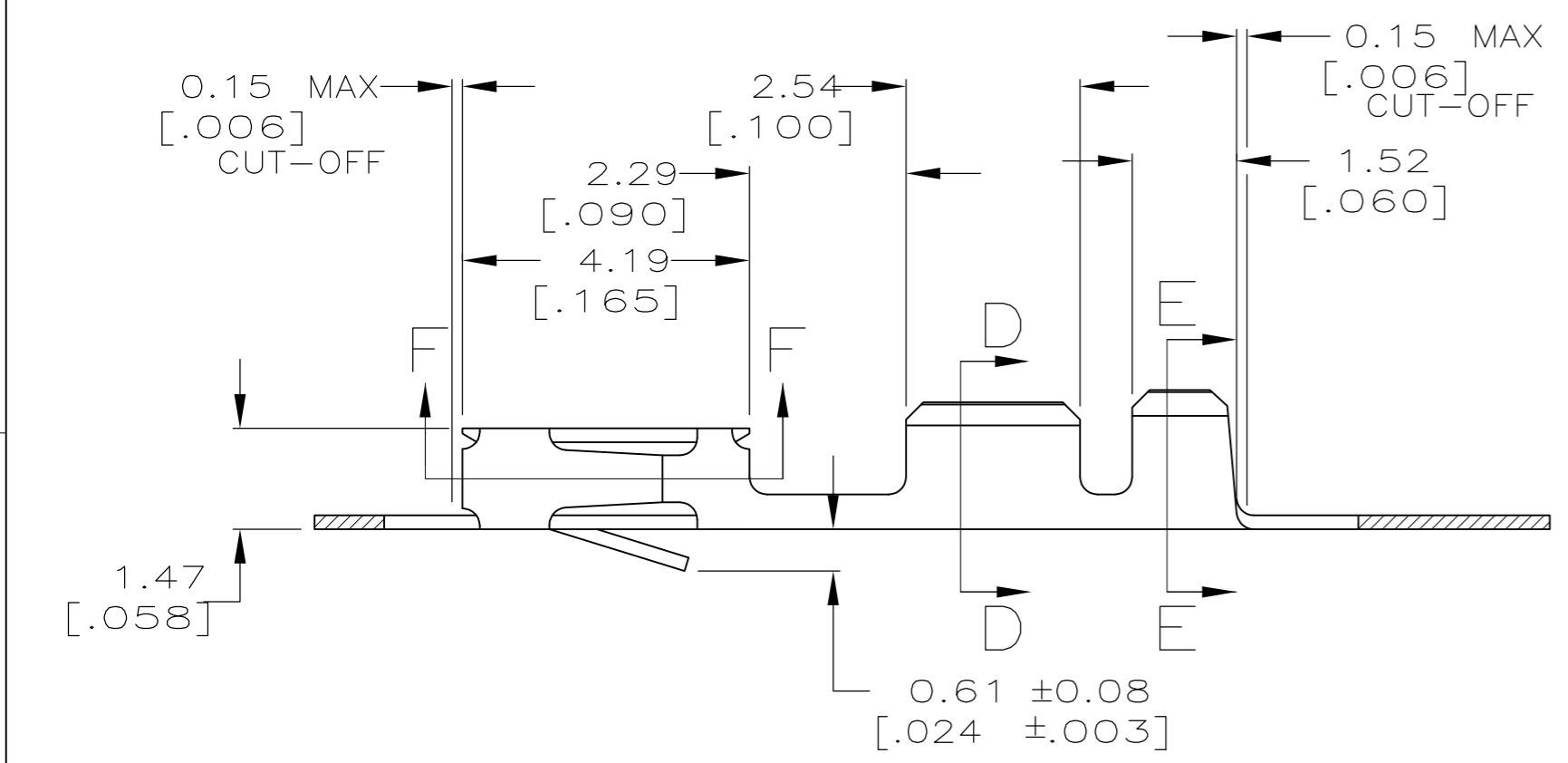
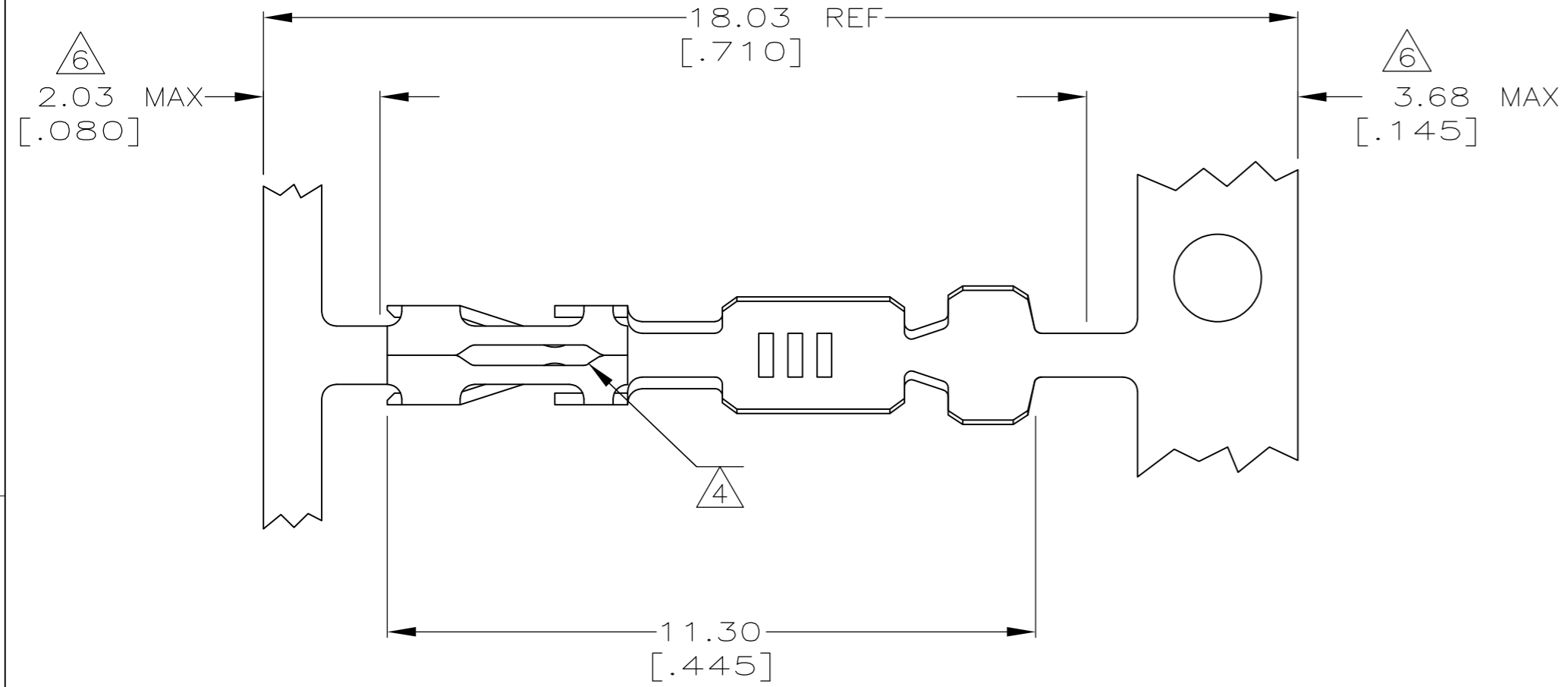

- ① REELED FOR MINI APPLICATOR.
 - ② FINISH: GOLD FLASH OVER 0.00127[.000050] NICKEL, 0.000381[.000015] GOLD IN CONTACT AREA.
 - ③ FINISH: GOLD FLASH OVER 0.00127[.000050] NICKEL, 0.00076[.000030] GOLD IN CONTACT AREA.
 - ④ CUT OUTS ON BOX AT MANUFACTURERS OPTION.
 - ⑤ POINT OF MEASUREMENT FOR PLATING THICKNESS (INSIDE BEAMS).
 - ⑥ GOLD PLATING NOT REQUIRED IN THIS AREA.
7. WIRE RANGE #22-#26, INSULATION RANGE Ø.061 MAX.

LOOSE PC.	③	102548-6
①	③	102548-5
LOOSE PC.	②	102548-3
①	②	102548-1
DESCRIPTION	FINISH	PART NUMBER

THIS DRAWING IS A CONTROLLED DOCUMENT.		DWN	S. SHUEY	5-6-92
DIMENSIONS: mm [INCHES]		CHK	J. GESFORD	5-20-92
TOLERANCES UNLESS OTHERWISE SPECIFIED:		APVD	-	-
0 PLC	± -	PRODUCT SPEC	-	-
1 PLC	± -	APPLICATION SPEC	-	-
2 PLC	± 0.13[.005]	WEIGHT	-	-
3 PLC	± -	CUSTOMER DRAWING	-	-
4 PLC	± -	SCALE	10:1	SHEET 1 of 1
ANGLES	± -	REV	J2	
MATERIAL	BERYLLIUM COPPER	FINISH	SEE TABLE	
THIS DRAWING IS A CONTROLLED DOCUMENT.				
NAME		CONTACT, CRIMP SNAP-IN, MOD IV 1/2		
SIZE	A2	CAGE CODE	00779	DRAWING NO
DRAWING NO		C=102548		