

PRODUCT NO.
 10031193-001LF
 10031193-002LF
 10031193-003C-TRLF

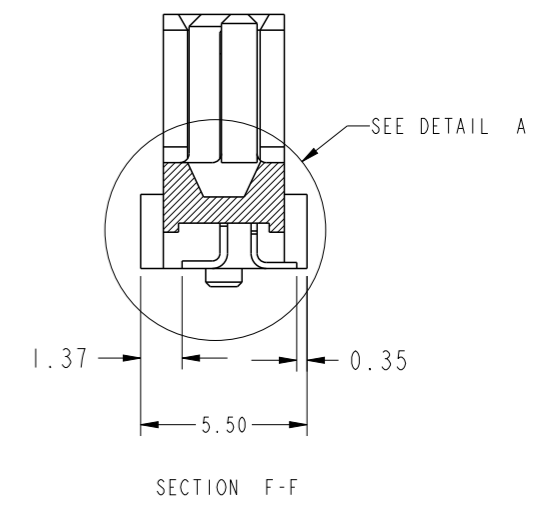
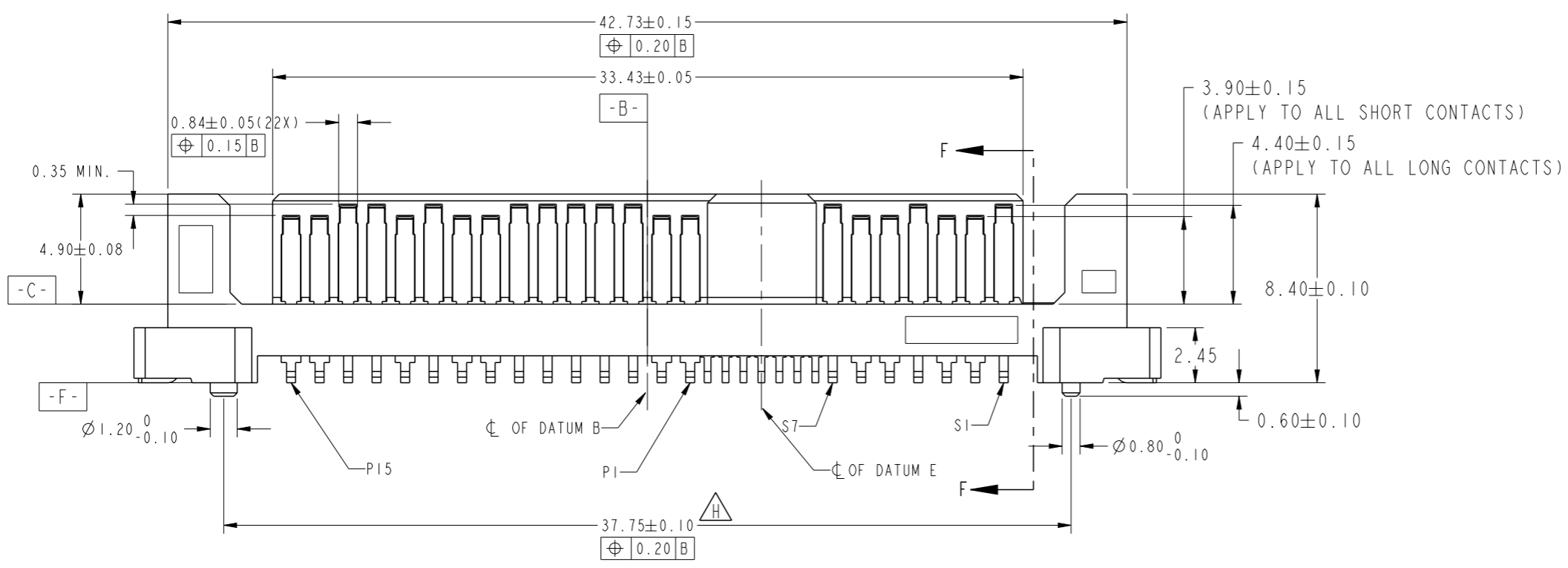
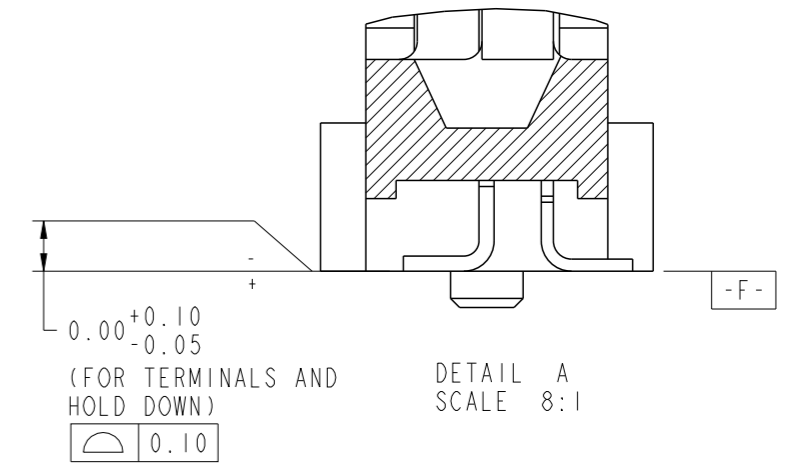
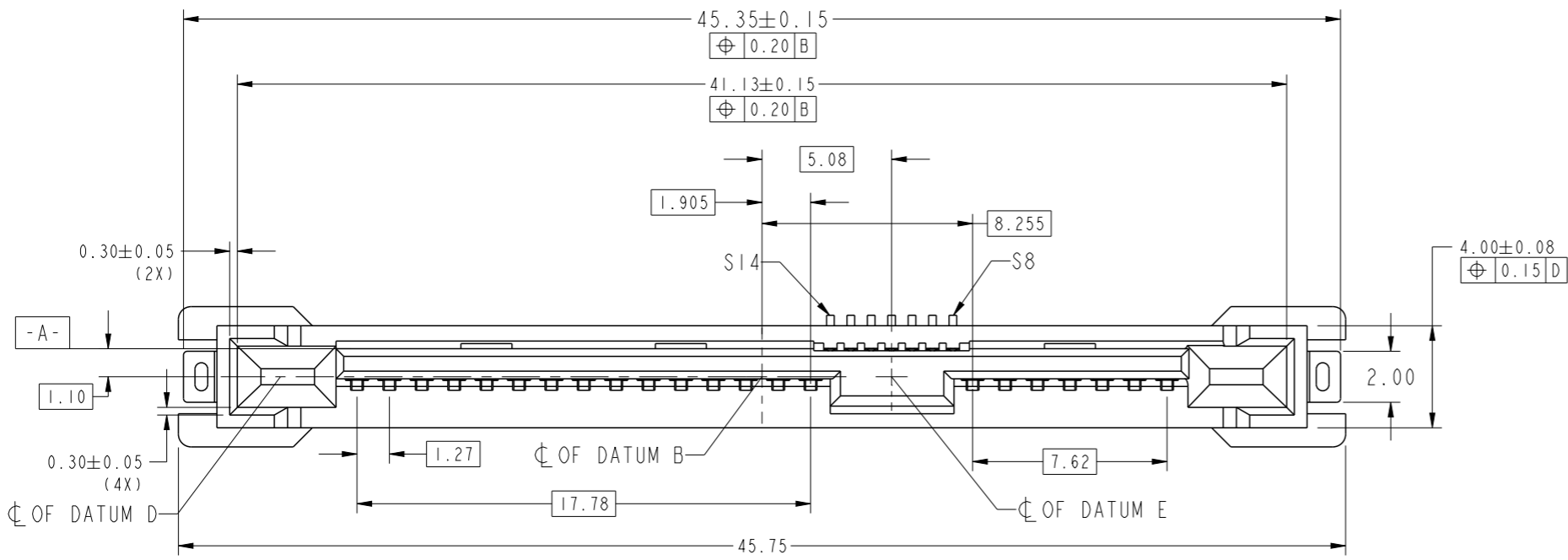

Amphenol FCI
 © 2016 AFCI

spec ref	dr	wcadmin	2005/01/27	projection	MM	size	A3	scale	4:1
tolerance std	eng	Jeffrey Lim	2016/09/08			ecn no	ELX-S-24900-1	rel level	Released
ASME Y14.5	chr	-	-						
surface	linear	0.X	±0.25	Amphenol FCI SAS PLUG VERTICAL SMT ASSY	cat. no.	Product - Customer Drw	sheet 1 of 3	dwg no 10031193	rev H
		0.XX	±0.13						
0.XXX	±0.050								
ASME Y14.5	angular	0°	±2°						

PRODUCT NO.
SEE TABLE

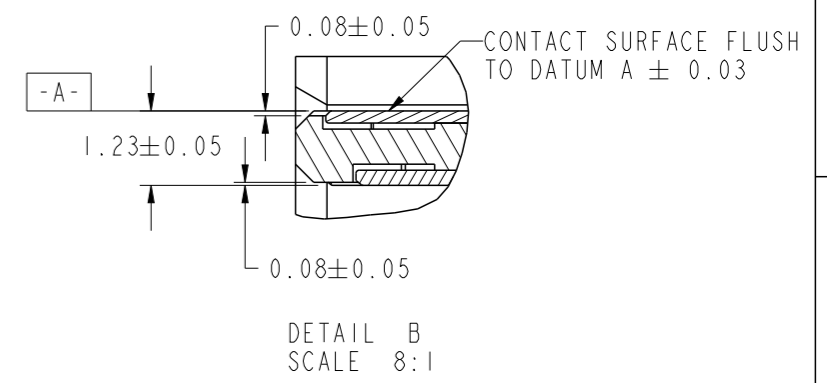
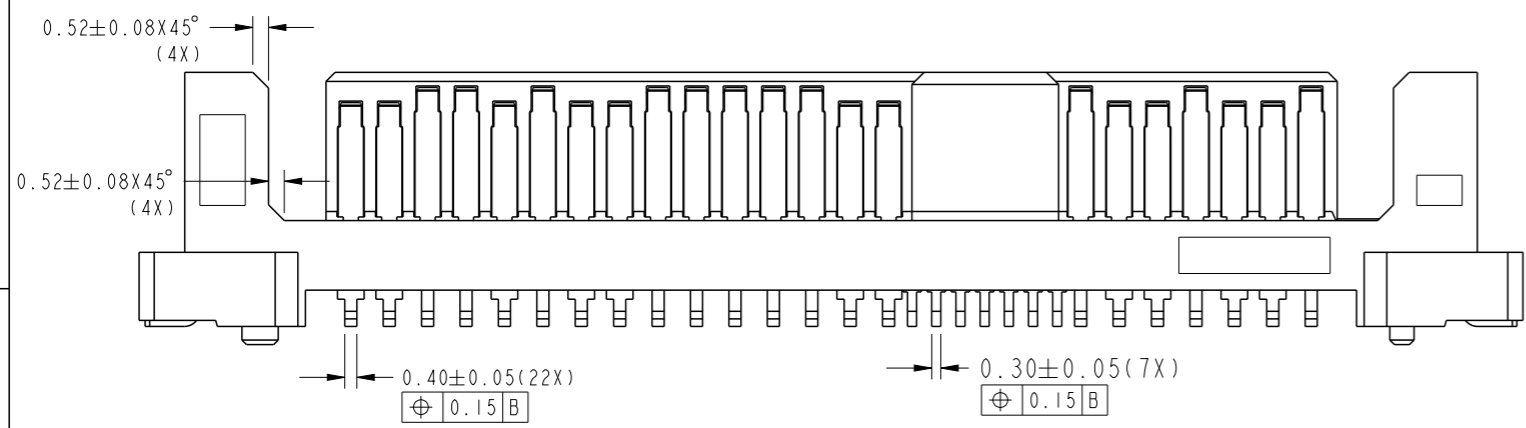
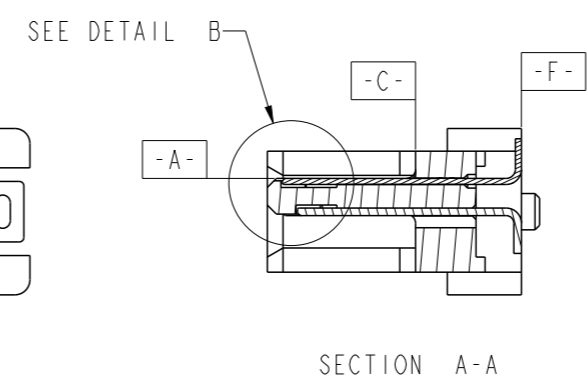
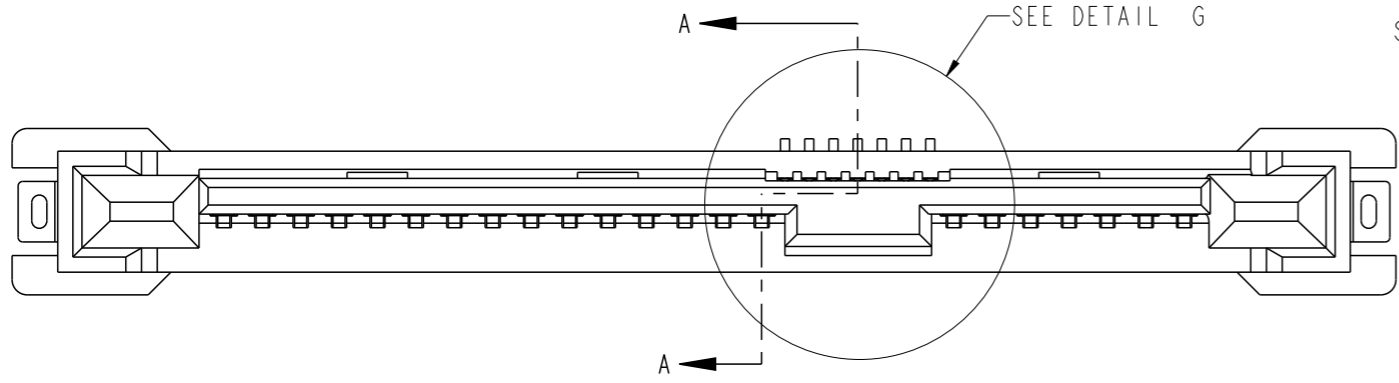
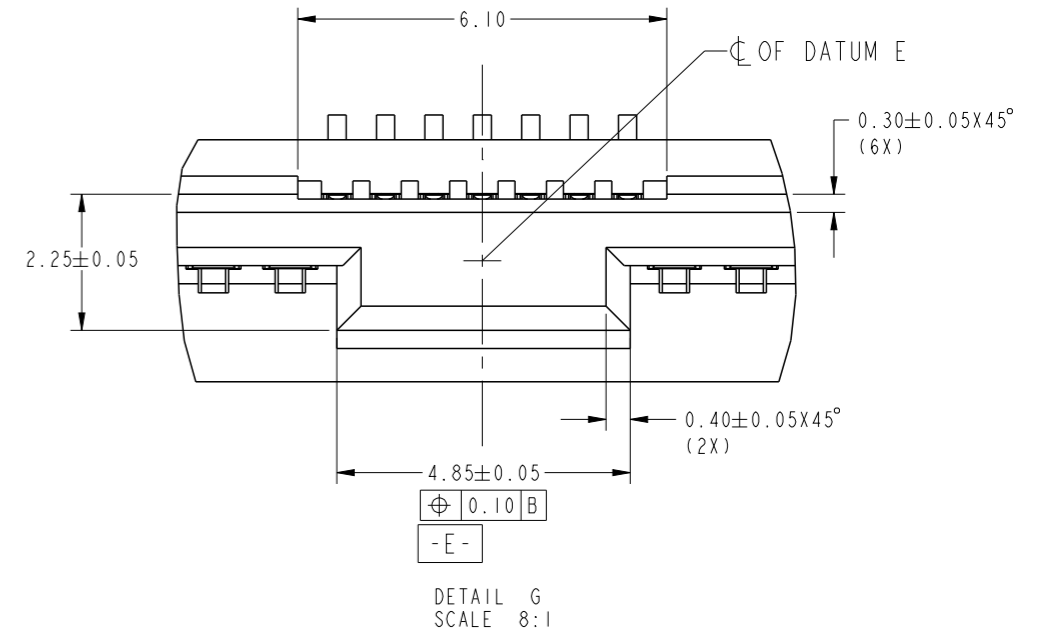
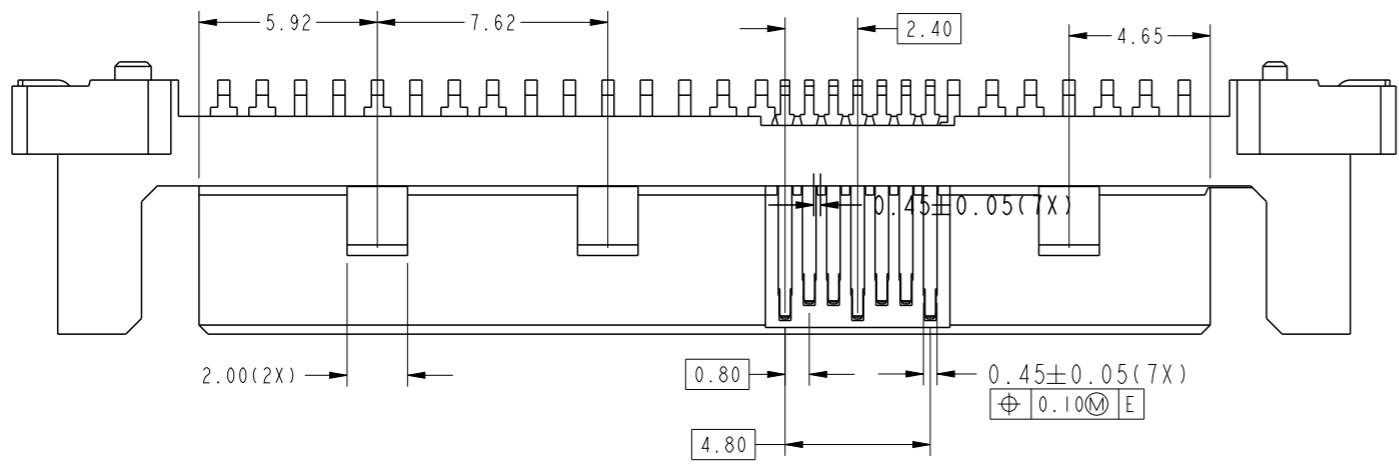

Amphenol FCI
© 2016 AFCI

spec ref				dr	wcadmin	2005/01/27	projection	MM	size	A3	scale	4:1
tolerance std	TOLERANCES UNLESS OTHERWISE SPECIFIED			eng	Jeffrey Lim	2016/09/08			ecn no	ELX-S-24900-1		
ASME Y14.5				chr	-	-			rel level	Released		
surface	linear	0.X	±0.25		SAS PLUG VERTICAL SMT ASSY			dwg no 10031193	rev H	Product - Customer Drw		
		0.XX	±0.13									
0.XXX	±0.050											
ASME Y14.5	angular	0°	±2°	cat. no.				sheet 2 of 3				

PRODUCT NO.	WITH PICK-UP CAP	PACKAGING	PLATING SPEC.
10031193-001LF/-002LF	NO	TRAY	-001LF REFER TO NOTE 2A
10031193-001CLF/-002CLF	YES		-002LF REFER TO NOTE 2B
10031193-001C-TRLF/-002C-TRLF		TAPE & REEL	NOTE 2A
10031193-003C-TRLF			

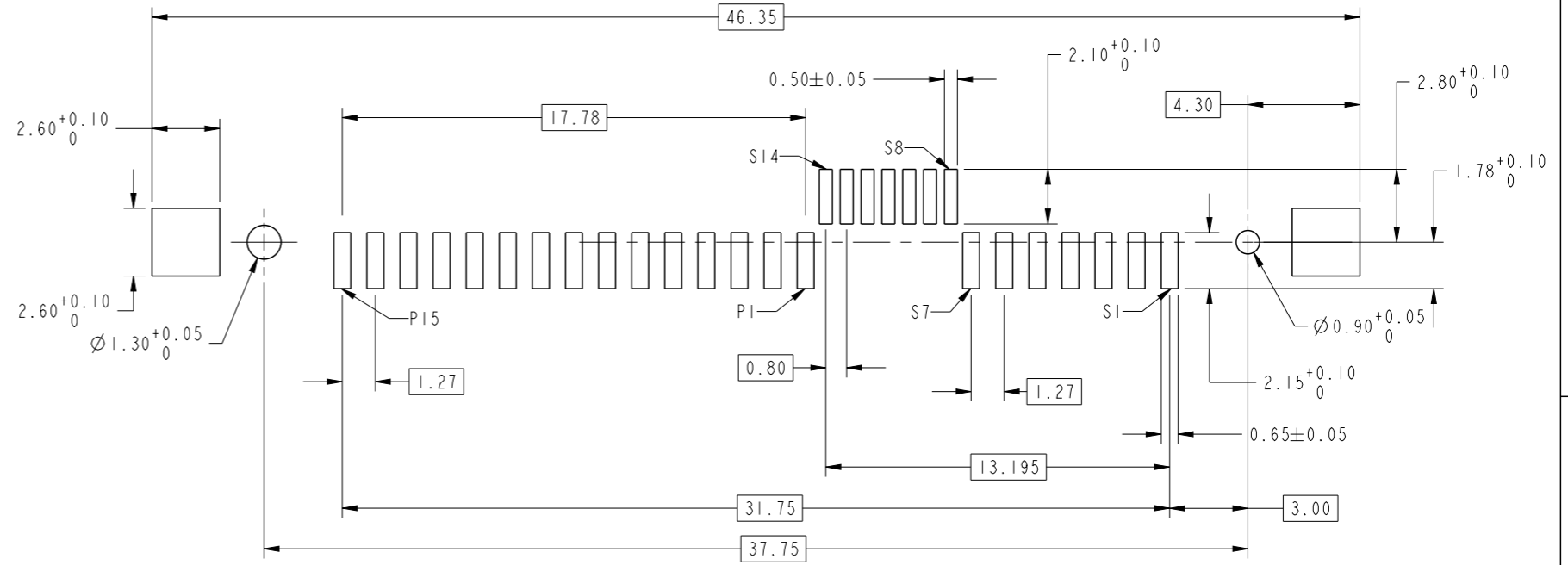
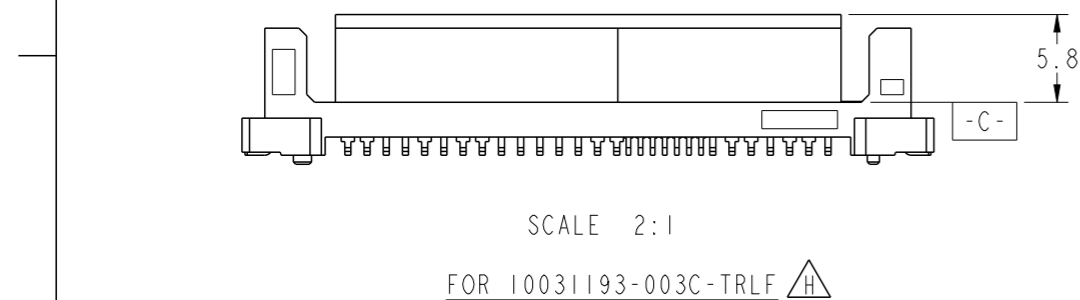
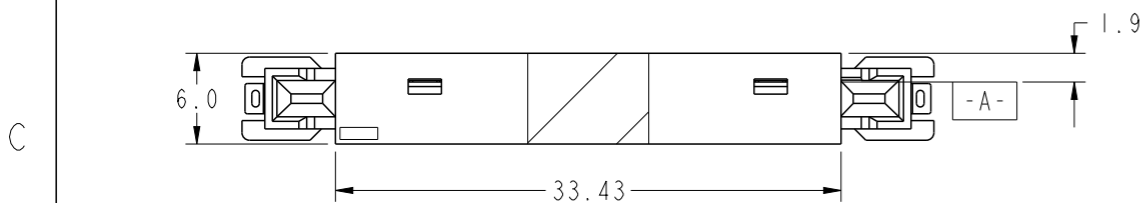
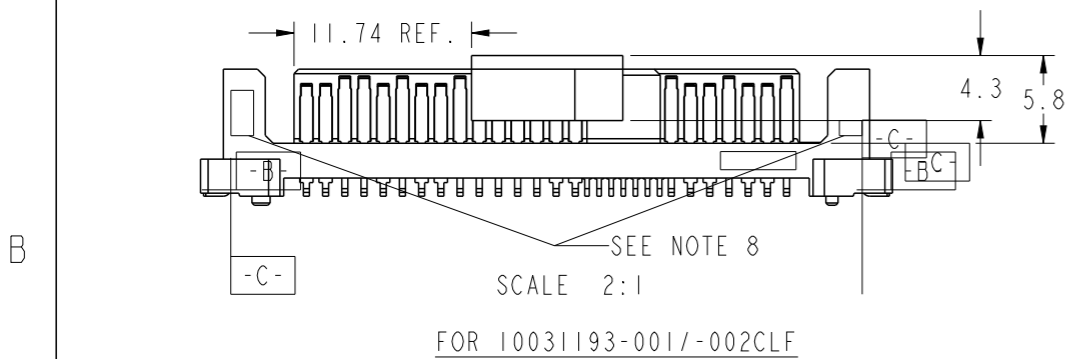
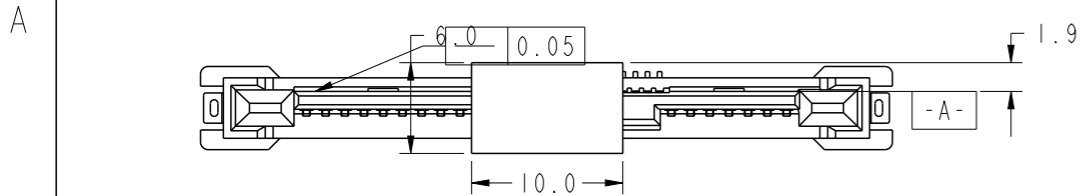

RECOMMENDED SOLDER PAD LAYOUT

NOTES:-

- MATERIAL:
HOUSING & PICK-UP CAP: HIGH TEMPERATURE PLASTIC, BLACK, UL94V-0
CONTACT & HOLD DOWN: COPPER ALLOY
- FINISH:
CONTACT: 1.27um MIN. NICKEL UNDERPLATE OVERALL, 1.9um MIN. 100% MATTE TIN ON SOLDER TAIL,
A) 0.76um MIN. GOLD ON CONTACT AREA
B) 0.76um MIN. GXT™ ON CONTACT AREA
HOLD DOWN: 2.54um MIN. 100% MATTE TIN OVER 1.27um MIN. NICKEL UNDERPLATE
- THIS PRODUCT MEETS EUROPEAN UNION DIRECTIVES AND OTHER COUNTRY REGULATIONS AS DESCRIBED IN GS-47-0004
- THE HOUSING WILL WITHSTAND EXPOSURE TO 260°C PEAK TEMPERATURE FOR 10 SECONDS IN A CONVECTION, INFRA-RED OR VAPOR PHASE REFLOW OVEN
- PART WITH PICK-UP CAP, P/N XXXXXXXX-XXXCLF
- FOR TAPE & REEL PACKAGING, P/N XXXXXXXX-XXXC-TRLF
- ASSY DIMENSIONS WITH REFERENCE TO SFF-8482
- THE PART SHALL HAVE "FCI" ID AND CAVITY NUMBER SHOWN IN THE APPROXIMATE LOCATION
- PRODUCT SPECIFICATION: GS-12-282
- PACKAGING SPECIFICATION: GS-14-952(TRAY); GS-14-1038(TAPE & REEL)
- A SYMBOL WILL BE NEXT TO ANY DIMENSION, VIEW OR NOTE WHICH HAS BEEN MODIFIED WITH THE CURRENT DRAWING REVISION

spec ref	dr	wcadmin	2005/01/27	projection	MM	size	A3	scale	4:1
tolerance std	eng	Jeffrey Lim	2016/09/08		← →	ecn no	ELX-S-24900-1	rel level	Released
ASME Y14.5	chr	-	-						
surface	linear	0.X	±0.25	Amphenol FCI	SAS PLUG	dwg no	10031193	rev	H
		0.XX	±0.13						
ASME Y14.5	angular	0.XXX	±0.050	cat. no.	Product - Customer Drw	sheet 3 of 3			
		0°	±2°						