

1

2

3

4

5

6

7

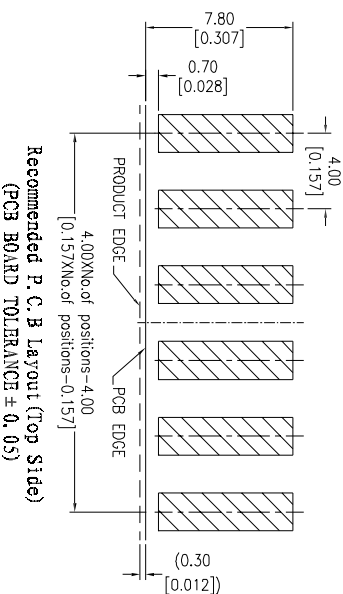
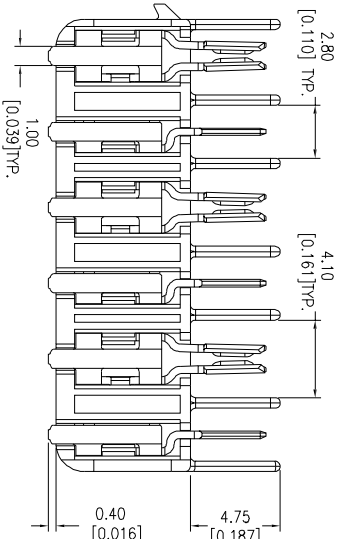
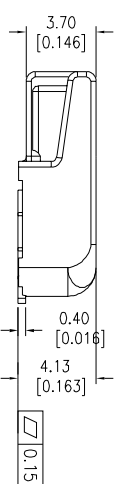
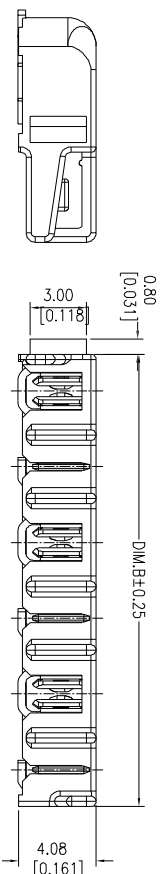
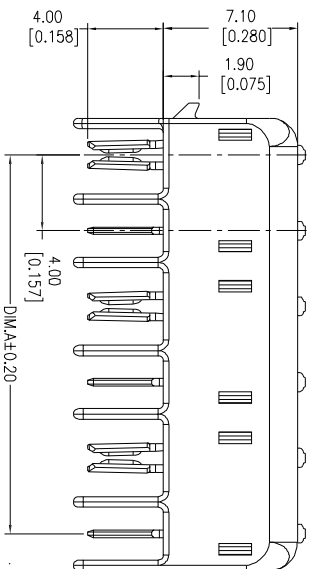

② ABTB-400-xx-SRX

1 = white insulator
2 = black insulator
xx = pin count

- Notes:
- Rated current: 6AMP
 - Contact resistance: 18MΩ max.
 - Withstand voltage: 1500V AC/DC
 - Insulation resistance: 1000MΩ min.
 - Operation temperature: -40°C to +105°C
 - Solder Temperature: 260°C, 5s
- Contact material: Phosphor Bronze
- ③ Contact plating: 100~200u" Matte Tin plated over 50u" Nickel
- ① Insulator material: LCP+30%G.F UL94V-0

RoHS compliant
Unit: mm



File No.: E198287

Scale Free

TOLERANCE

X ±0.40

.XX ±0.25

.XXX ±0.15

DIM TOL

Angle ±1.5°

④ Add the UL File No.

③ Add and modify note

② Add black color part

① Update the insulator color

① Drawn

Date

27.07.2017

17.08.2016

25.05.2016

13.04.2016

28.01.2016

Name

Winnie

Ray

Ray

Ray

Date

28.01.2016

27.07.2017

Winnie

Ray

Name

Ray

Winnie

Winnie

Winnie

Customer-No.

ASSMANN WSW-No.

② ABTB-400-xx-SRX

Drawing-No.

ASS 7120 CO

No. Of PIN

02

04

06

DIM.A

4.00

12.00

20.00

DIM.B

7.90

15.90

23.90

1

2

3

4

5

6

7

SV4C

ASSMANN
WSW components

ASS 7120 CO

② ABTB-400-xx-SRX

Drawing-No.

ASS 7120 CO

rev04

Replace

Sheet