

REVISIONS				
P.	LTN	DESCRIPTION	DATE	APVD
A15		REVISED PER ECO-11-002569	25FEB2011	DLD DCM
A16		REVISED PER ECO-14-011102	22JUL2014	DLD DCM

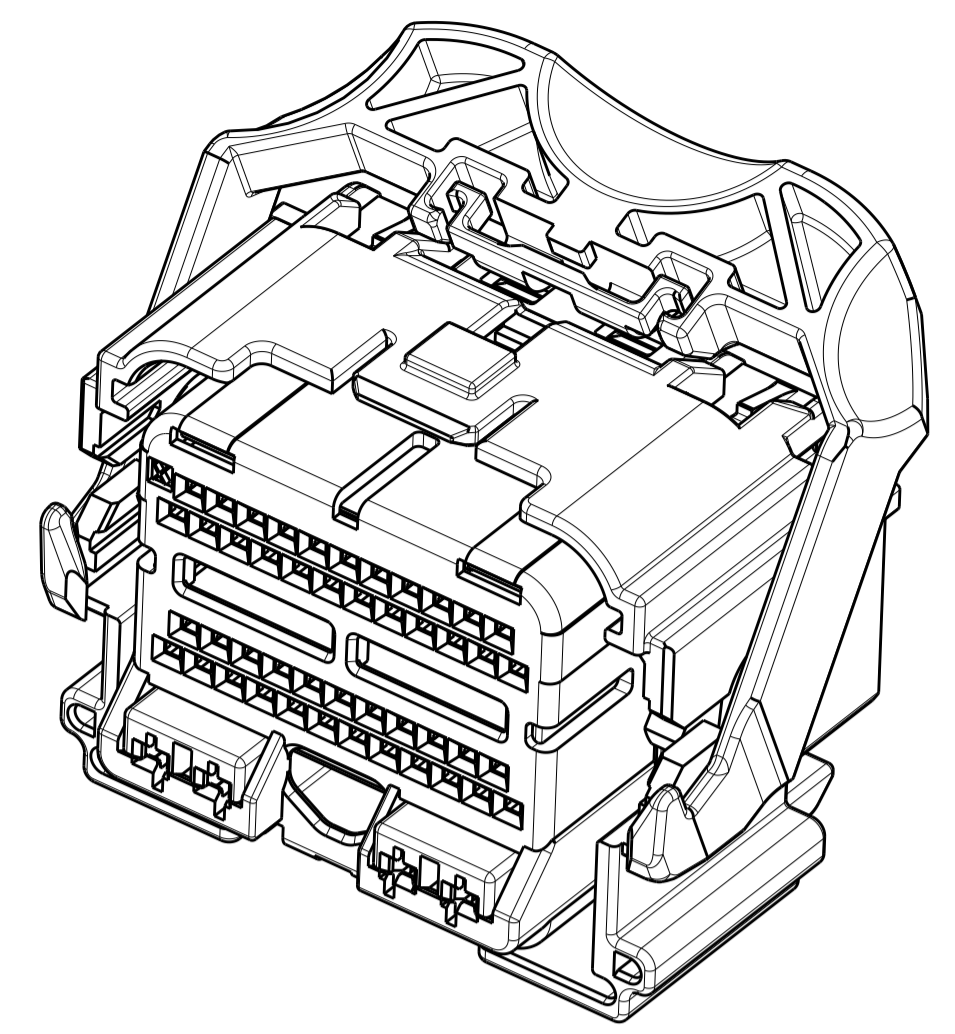

PART NUMBER:
1438691-1
SHOWN WITH SPACER
IN SEATED POSITION
SCALE 2:1

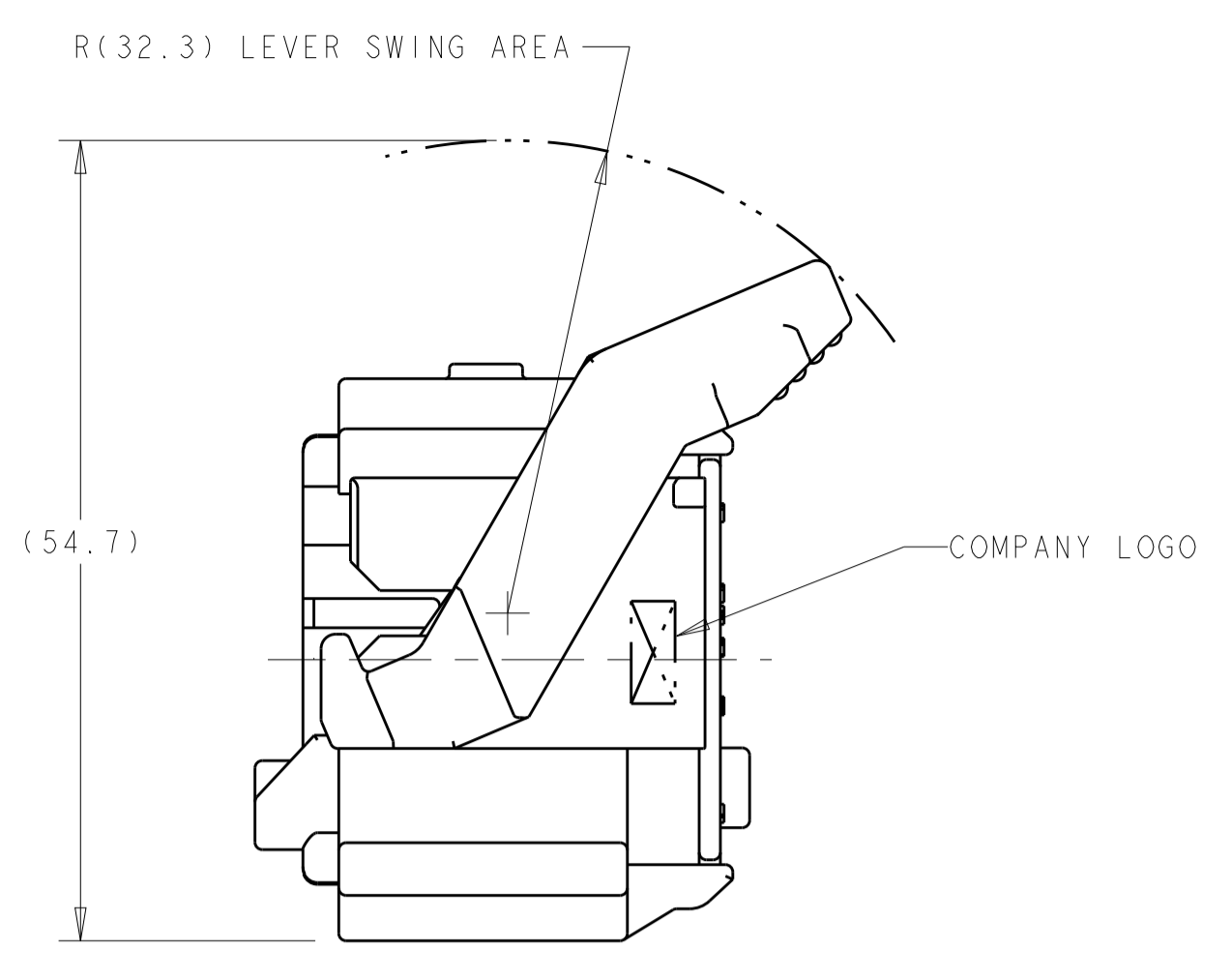
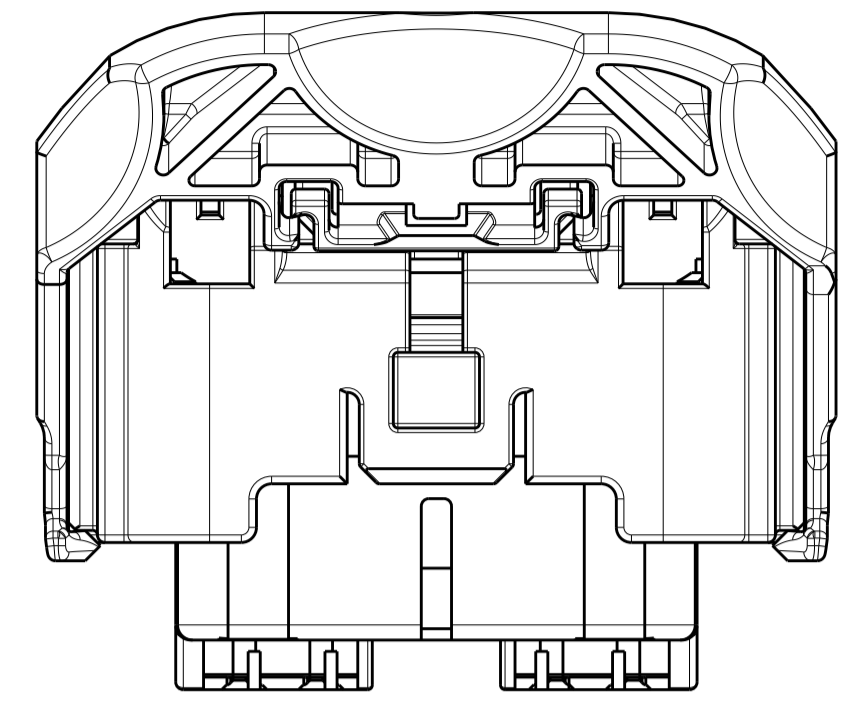

SHOWN WITH SPACER IN SEATED POSITION

- △ PRINT TE PART NUMBER AND TRACEABILITY (YY : 2 DIGIT YEAR, JJJ = JULIAN DATE, HH = 2 DIGIT MILITARY HOUR CODE) IN THE LOCATION AT ASSEMBLY.
- △ OPTIONAL WIRE SHIELD PART NUMBERS (SOLD SEPARATELY) 1438126, 1438180, 1488373, AND 1488572. CONTACT TE ENGINEERING FOR MINIMUM FEED THRU CONDITION.
- 3. APPLICABLE TERMINAL PART NUMBERS (SOLD SEPARATELY) FOR TIN APPLICATIONS: 1393367 AND 1393366. FOR GOLD APPLICATIONS: 1393365 AND 1393364 FOR TERMINATION AND REELING OPTIONS SEE DRAWINGS 1393367, 1393366, 1393365, AND 1393364.
- 4. APPLICABLE MOLEX (1.5) POWER TERMINAL PART NUMBERS: 33012-0002 TIN 0.50-1.50mm²
- 5. CAM LEVER AND SPACER ARE SHIPPED IN THEIR PRE-ASSEMBLED POSITIONS.
- 6. REFERENCE TE INSTRUCTION SHEET 408-8893.

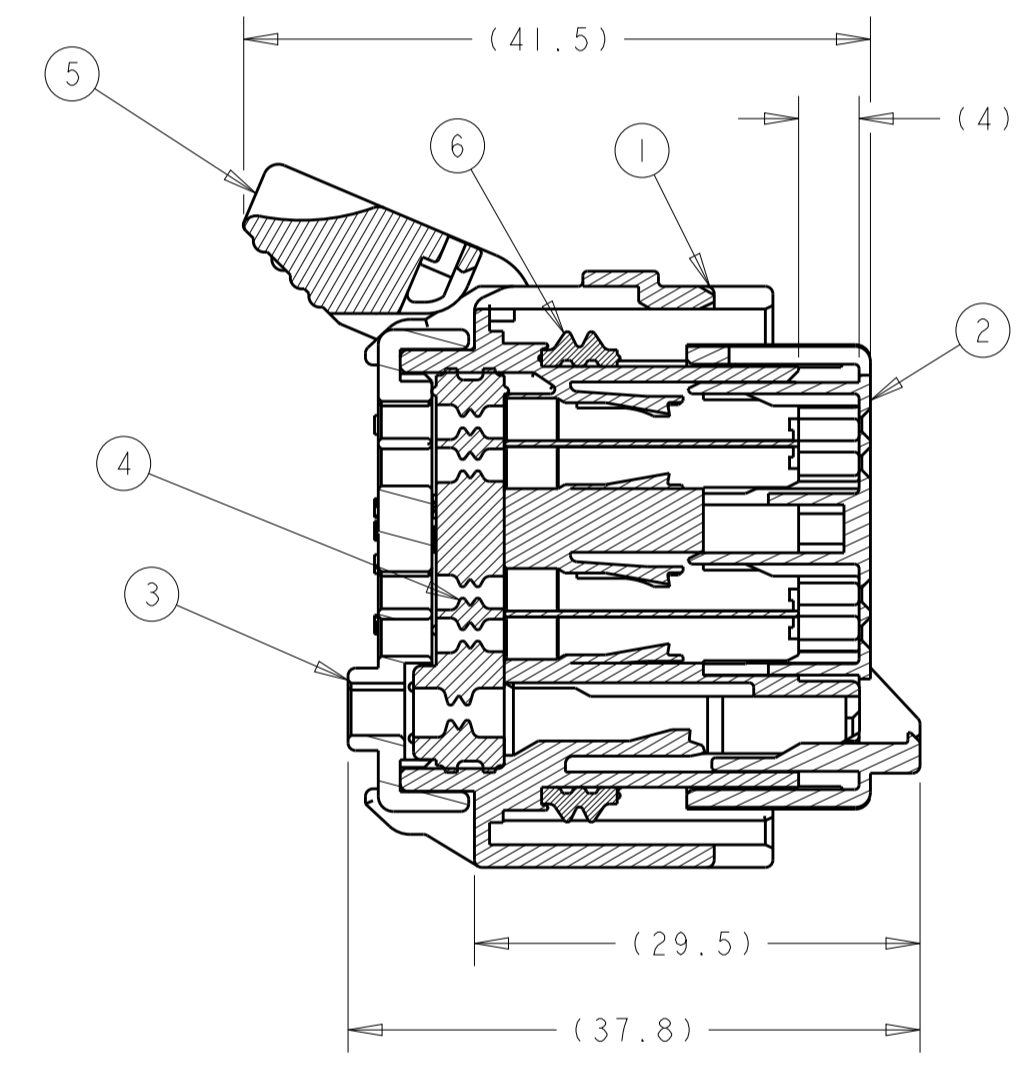

SECTION A-A
SPACER AND LEVER IN
PRE-SEATED POSITION
(DELIVERY CONDITION)

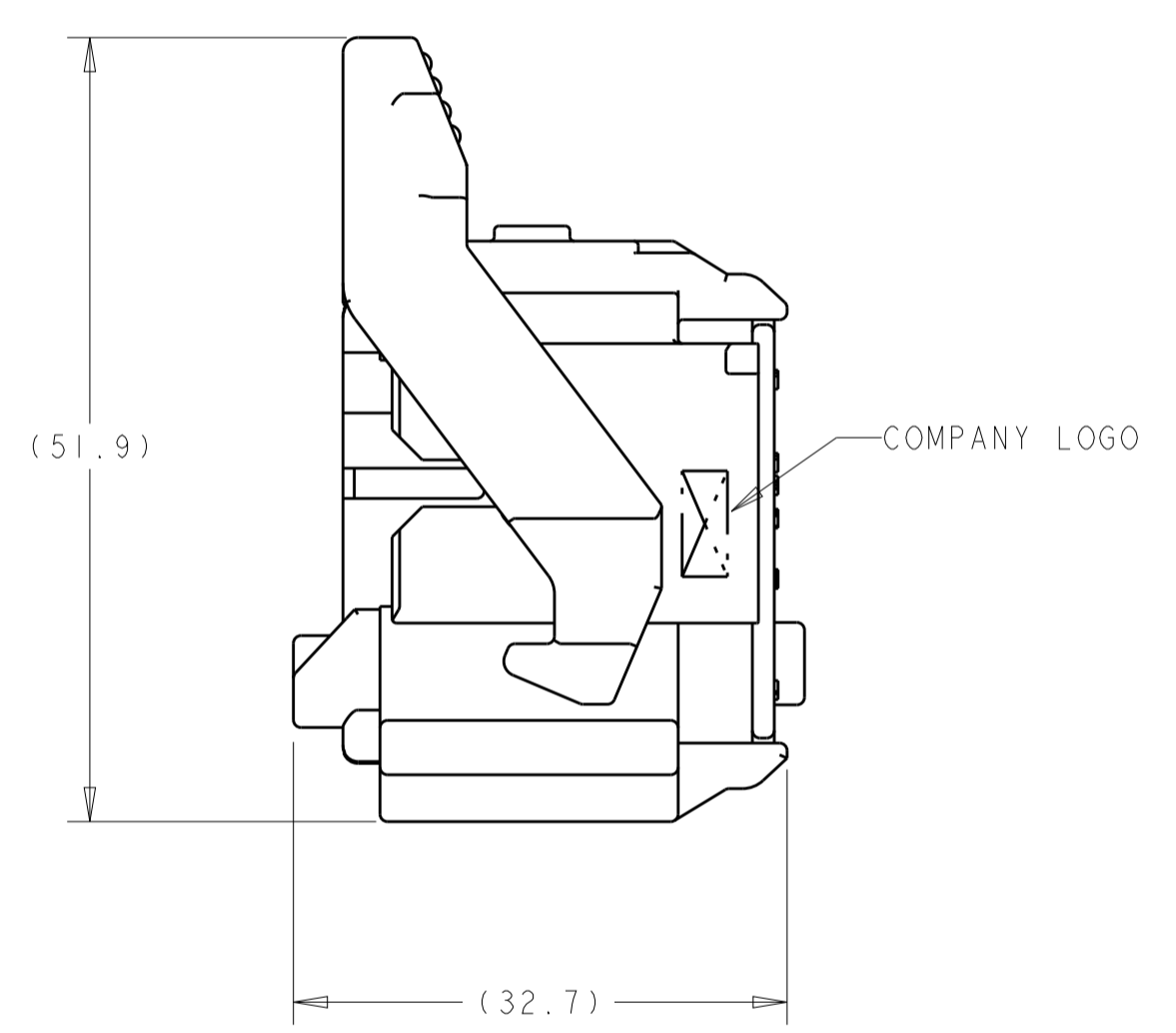
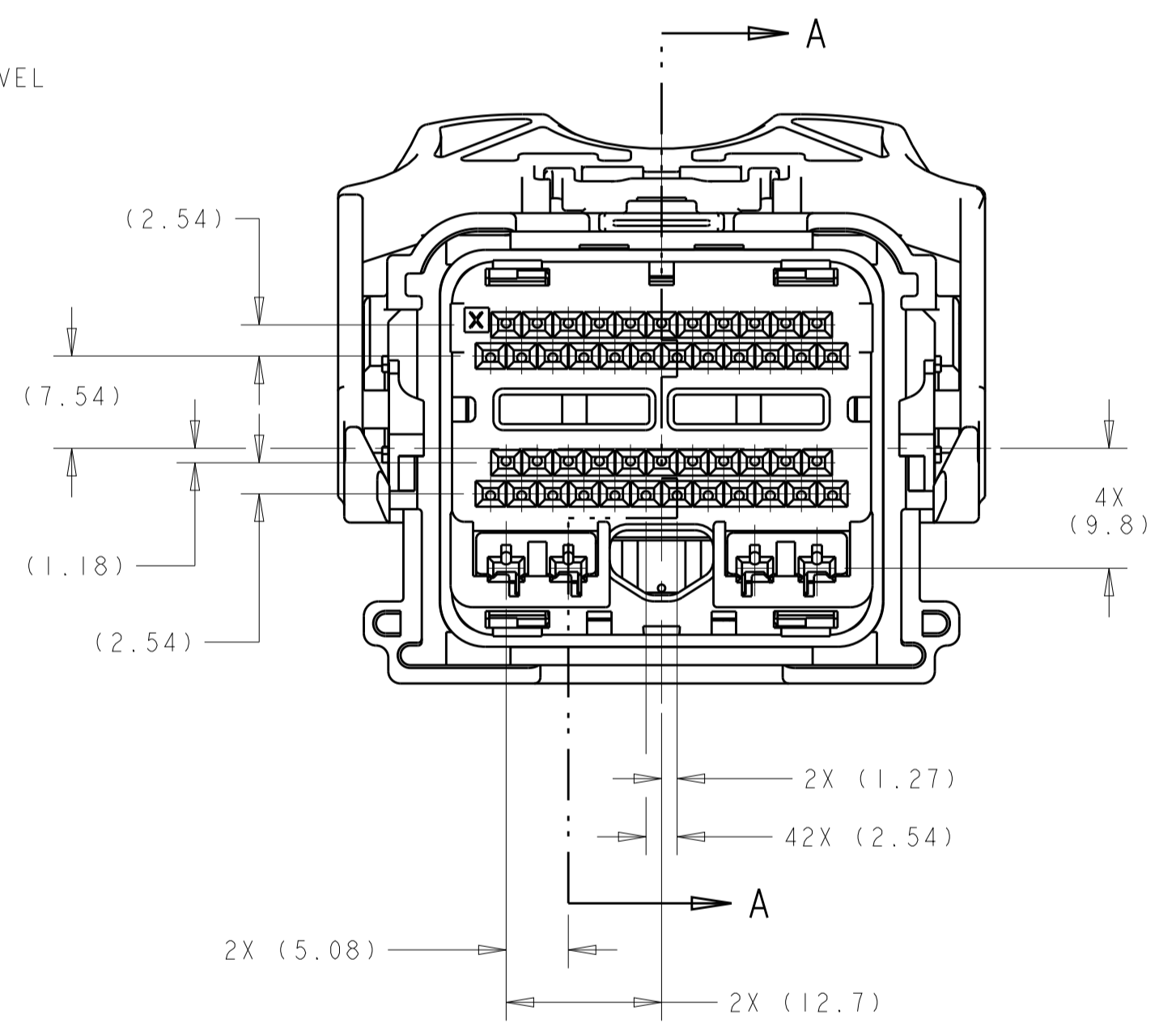

SHOWN WITH CAM
LEVER AND SPACER
IN LOADED POSITION

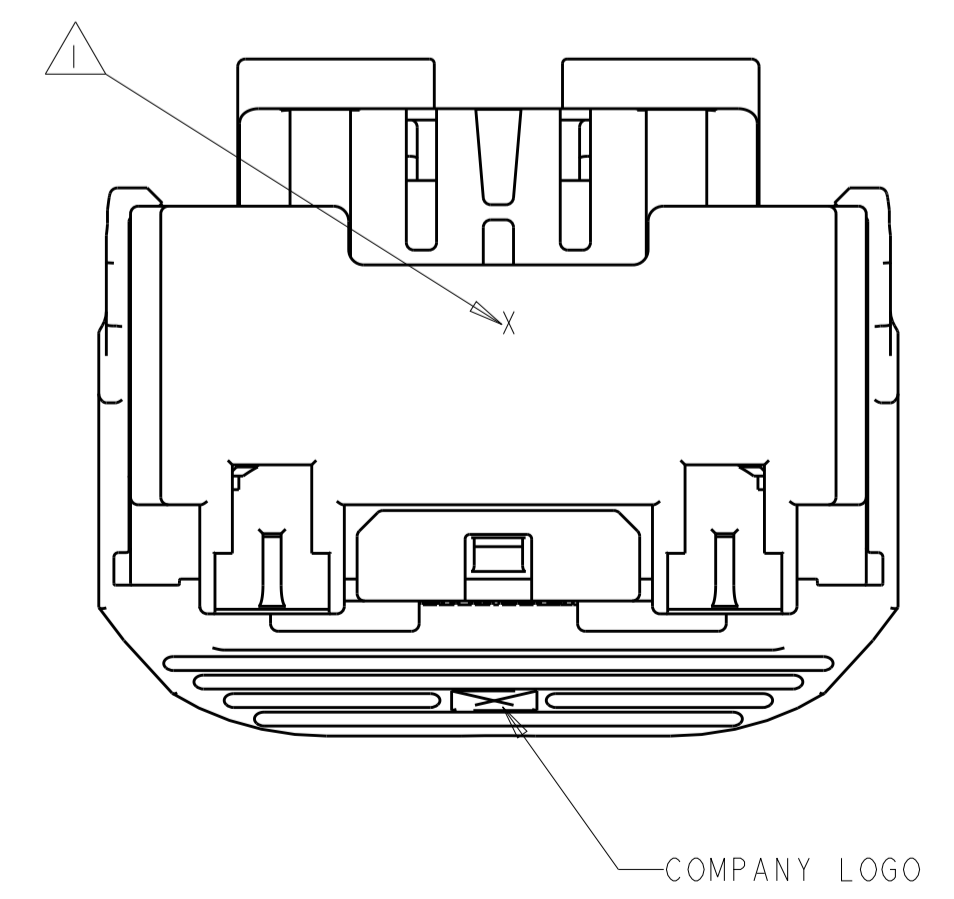

COMPANY LOGO

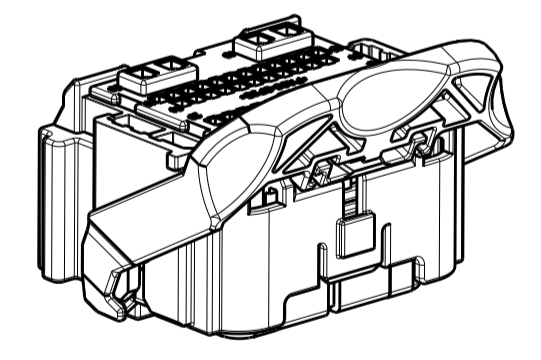

SCALE 1:1

GREEN	PERIMETER SEAL	6
GRAY	LEVER	5
BROWN	GROMMET SEAL	4
BLACK	COVER	3
RED	SPACER	2
BLACK	HARNESS, KEY "A"	1
PART COLOR	DESCRIPTION	ITEM NO.

THIS DRAWING IS A CONTROLLED DOCUMENT.		OWN: B. CRISAMORE 21 JUL 2004	NAME: ASSEMBLY, 50-WAY, KEY A, PCM HARNESS
DIMENSIONS: mm		CHK: M. HITCHCOCK 21 JUL 2004	SIZE: A100779
TOLERANCES UNLESS OTHERWISE SPECIFIED:		APVD: C. MARTIN 21 JUL 2004	CAGE CODE: 1438691
0 PLC	±	PRODUCT SPEC	RESTRICTED TO: -
1 PLC	±0.3	APPLICATION SPEC	SCALE: 2:1
2 PLC	±0.10	WEIGHT	SHEET 1 OF 4
3 PLC	±	Customer Drawing	REV: A16
4 PLC	±		
ANGLES	±1°		
FINISH	-		

APPLICABLE HEADER INTERFACE SPECIFICATION

SHOWN WITHOUT KEYING OPTIONS

REVISIONS				
P.	LTN.	DESCRIPTION	DATE	OWN. APVD.
-	-	SEE SHEET 1	-	-

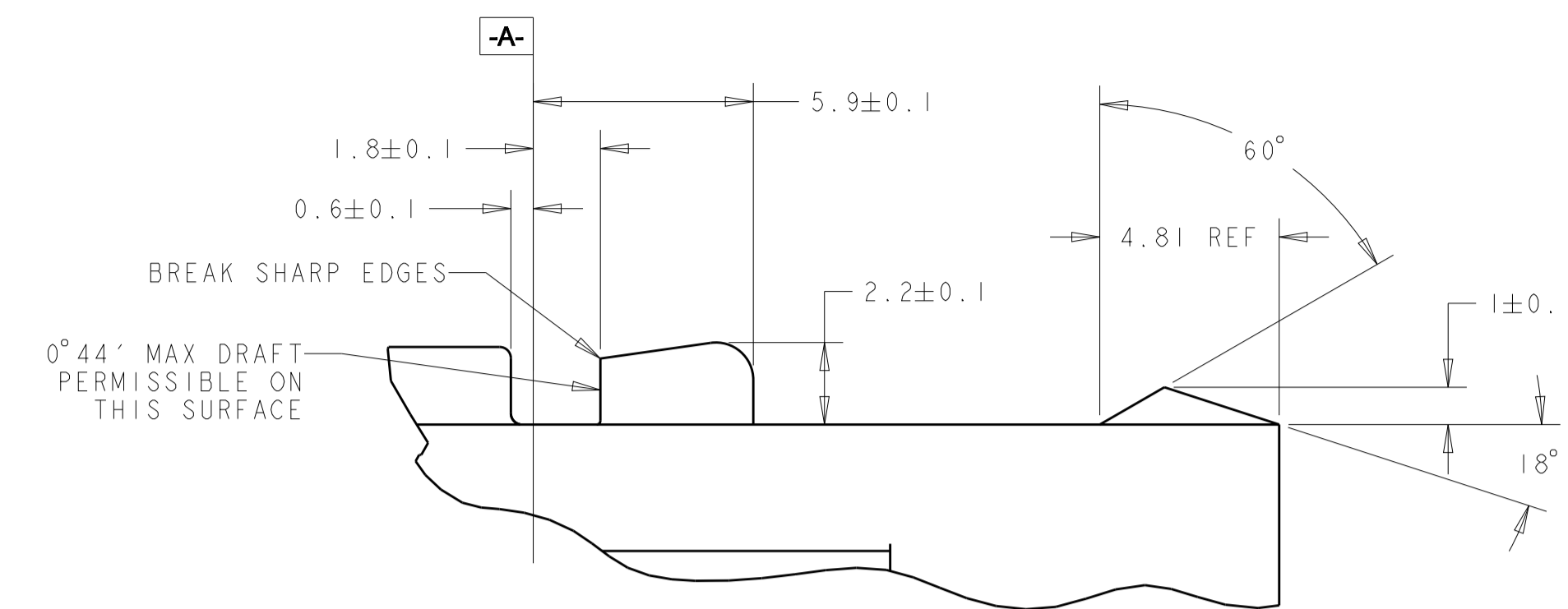

DETAIL F
SCALE 6:1

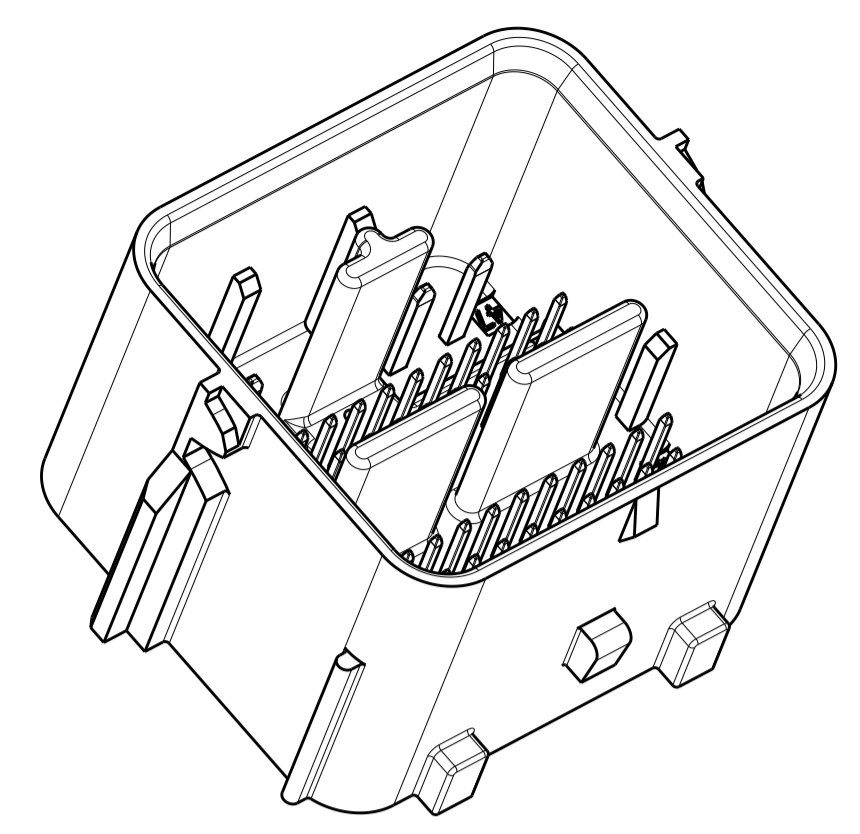
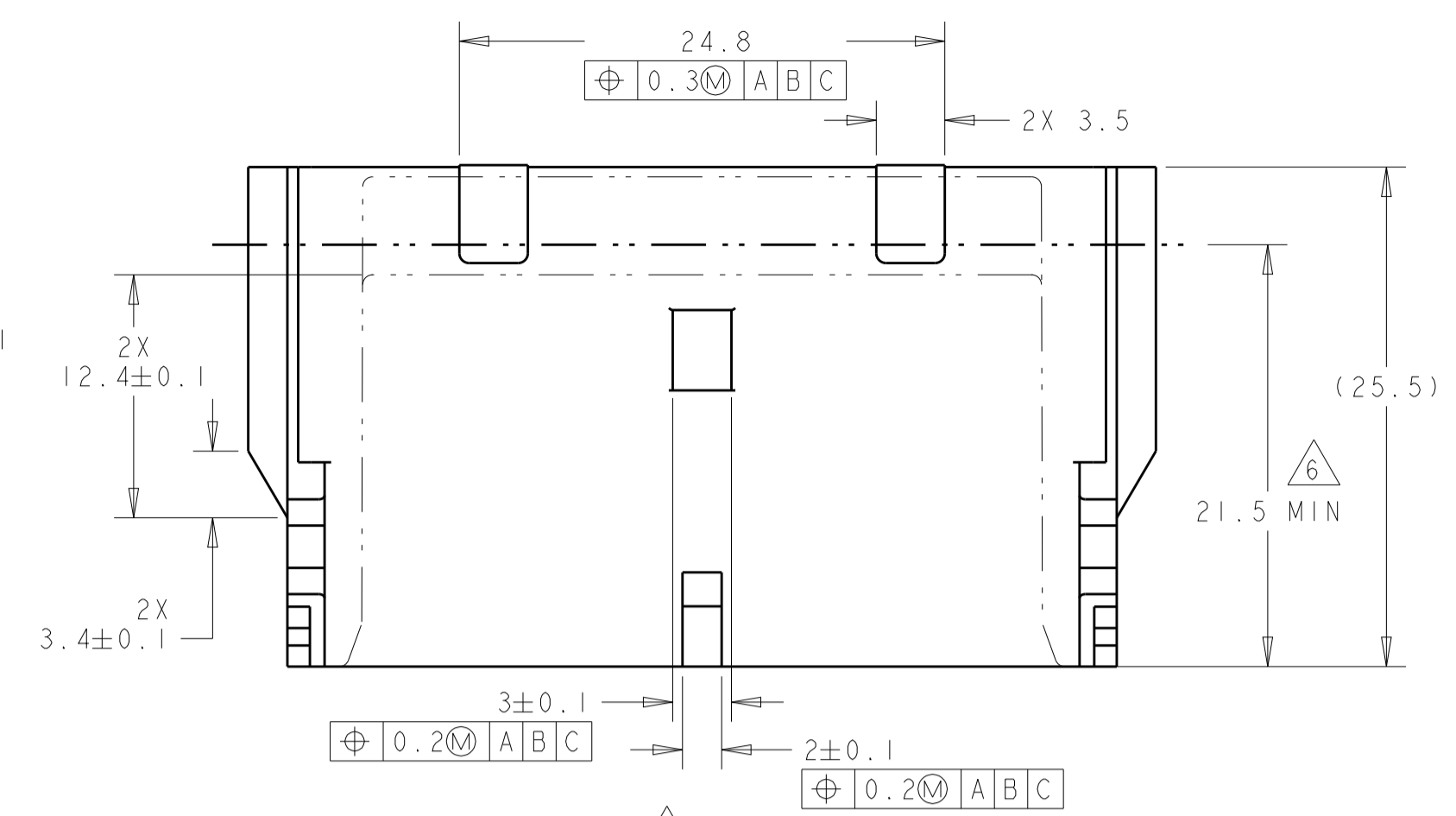

SCALE 2:1

- NOTES: UNLESS OTHERWISE SPECIFIED
- GENERAL TOLERANCE:
±0.3 ALL ONE PLACE DIMENSIONS
±0.10 ALL TWO PLACE DIMENSIONS
±1°00' ALL ANGULAR DIMENSIONS
 - DRAFT ANGLE PERMISSIBLE ONLY WITHIN DRAWING TOLERANCE.
 - SEALING SURFACE, NO WITNESS LINES OR DAMAGE PERMITTED.
 - ALL UNMARKED RADII TO BE 0.5 MAX., UNLESS OTHERWISE SPECIFIED.
 - VENT HOLE SIZE AND LOCATION IS OPTIONAL.
 - THIS AREA TO REMAIN CLEAR FOR THE HARNESS ASSEMBLY.
 - TERMINAL POSITION IDENTIFICATION.

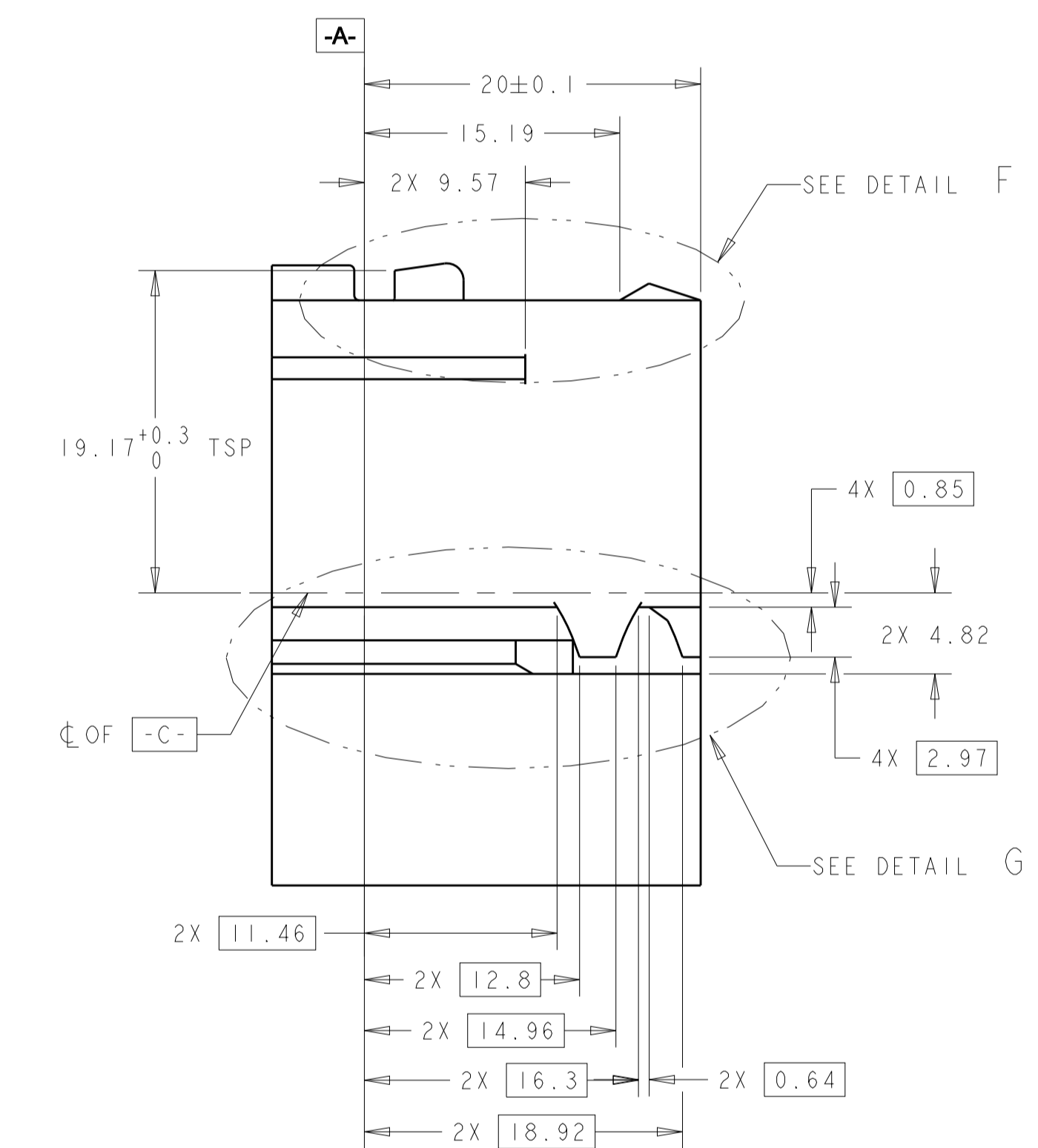

DETAIL G
SCALE 6:1
2 PLC

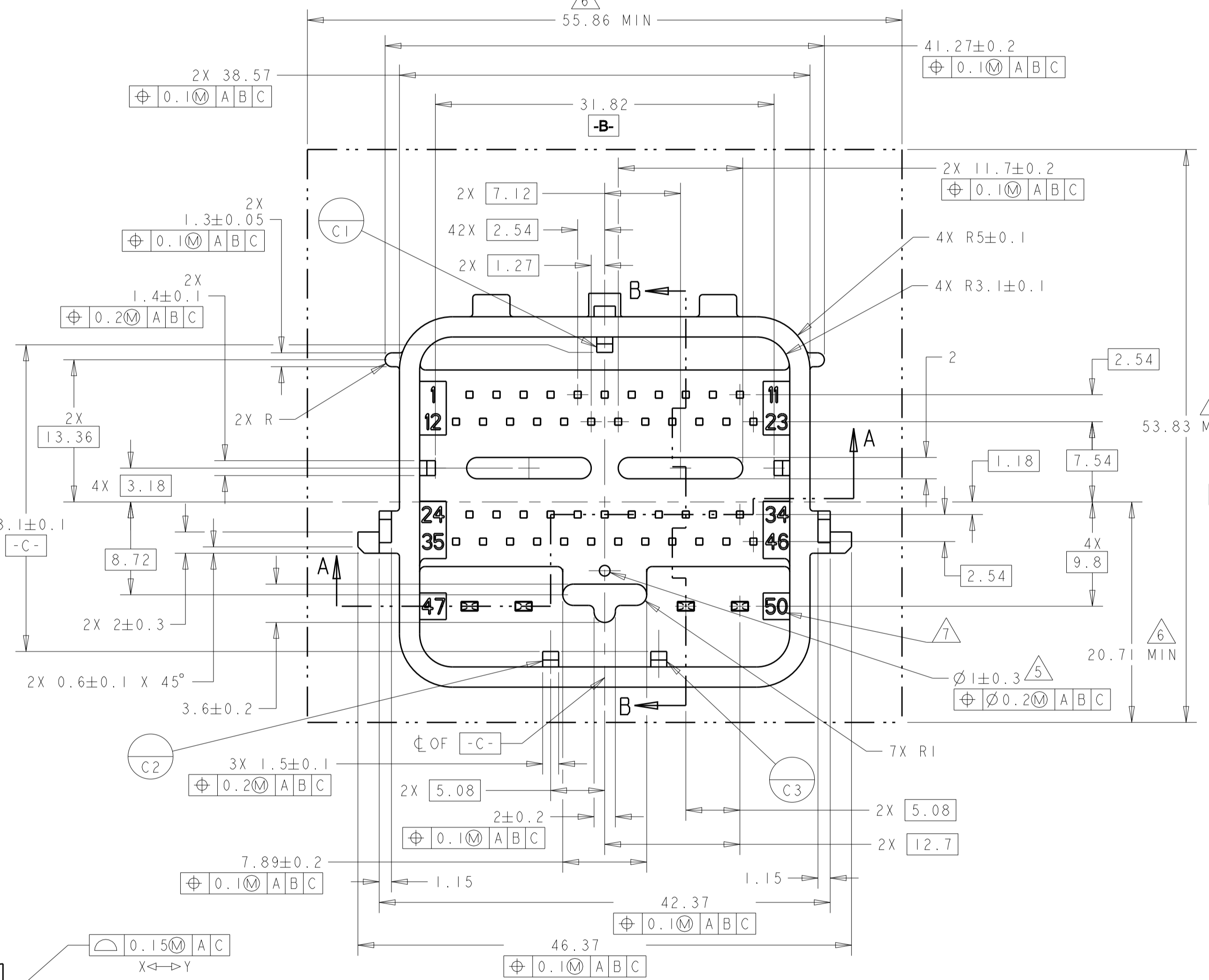

SECTION A-A

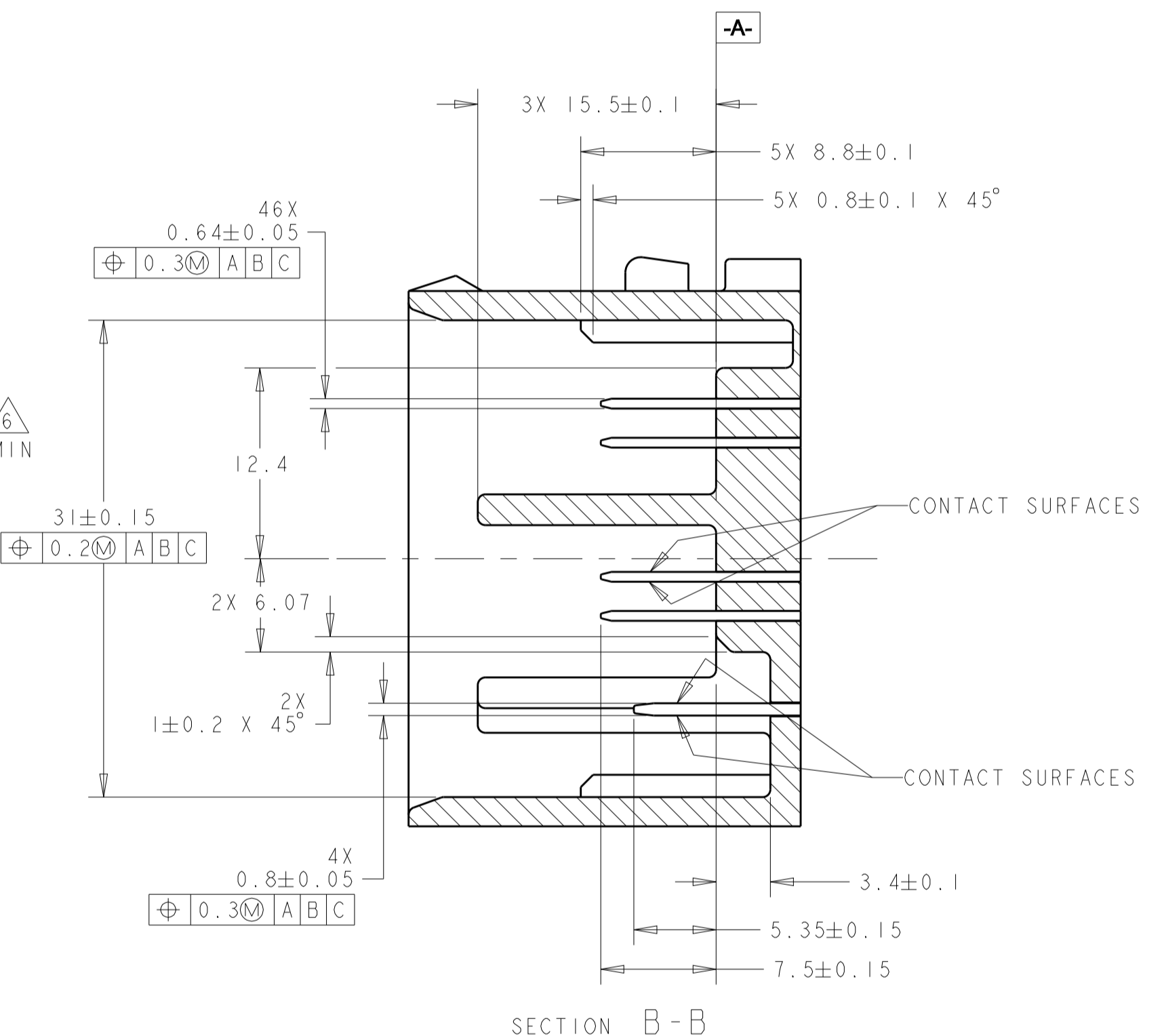

SECTION B-B

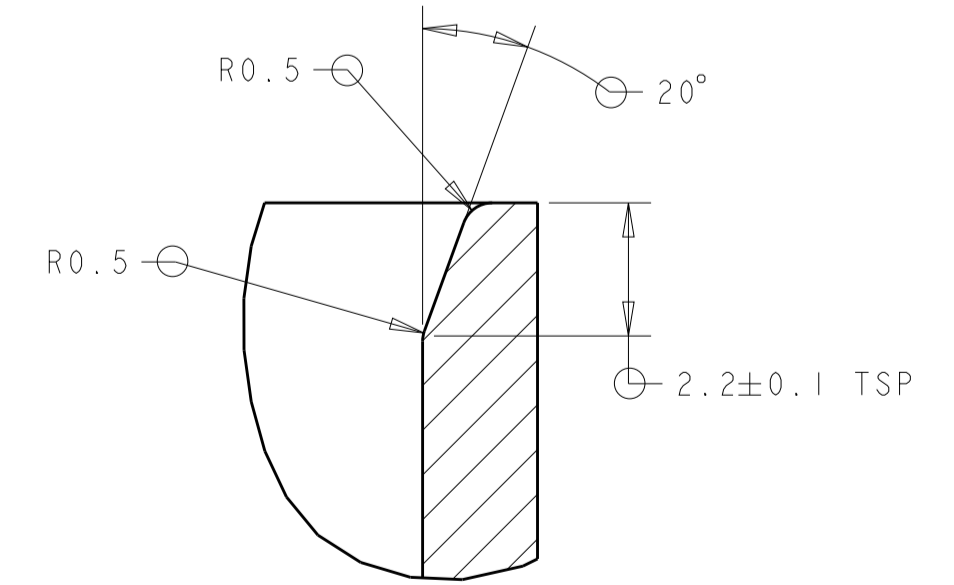

DETAIL E
SCALE 8:1

THIS DRAWING IS A CONTROLLED DOCUMENT.		OWN. B. CRISAMORE 21 JUL 2004	TE Connectivity												
DIMENSIONS: mm		CHK. M. HITCHCOCK 21 JUL 2004													
TOLERANCES UNLESS OTHERWISE SPECIFIED:		APVD. C. MARTIN 21 JUL 2004	NAME ASSEMBLY, 50-WAY, KEY A, PCM HARNESS												
<table border="1"> <tr><td>0 PLC</td><td>±</td></tr> <tr><td>1 PLC</td><td>±0.3</td></tr> <tr><td>2 PLC</td><td>±0.10</td></tr> <tr><td>3 PLC</td><td>±</td></tr> <tr><td>4 PLC</td><td>±</td></tr> <tr><td>ANGLES</td><td>±1°</td></tr> </table>		0 PLC	±	1 PLC	±0.3	2 PLC	±0.10	3 PLC	±	4 PLC	±	ANGLES	±1°	PRODUCT SPEC	SIZE CAGE CODE DRAWING NO. RESTRICTED TO
0 PLC	±														
1 PLC	±0.3														
2 PLC	±0.10														
3 PLC	±														
4 PLC	±														
ANGLES	±1°														
MATERIAL FINISH		WEIGHT	A100779C=1438691												
		Customer Drawing	SCALE 2:1 SHEET 2 OF 4 REV A16												

REVISIONS				
P.	LTN	DESCRIPTION	DATE	APP'D
-	-	SEE SHEET 1	-	-

KEYING OPTION A

46	45	44	43	41	39	38	37	36	35	33	32	31	29	28	23	22	21	19	18	13	6	5	4	3	2	1	ASSEMBLY PART NUMBER
																											6-1438691-8
																											6-1438691-7
																											6-1438691-6
																											6-1438691-5
																											6-1438691-4
																											6-1438691-3
																											6-1438691-2
																											6-1438691-1
																											6-1438691-0
																											5-1438691-9
																											5-1438691-8
																											5-1438691-7
																											5-1438691-6
																											5-1438691-5
																											5-1438691-4
																											5-1438691-3
																											5-1438691-2
																											5-1438691-1
																											5-1438691-0
																											4-1438691-9
																											4-1438691-8
																											4-1438691-7
																											4-1438691-6
																											4-1438691-5
																											4-1438691-4
																											4-1438691-3
																											4-1438691-2
																											4-1438691-1
																											4-1438691-0
																											3-1438691-9
																											3-1438691-8
																											3-1438691-7
																											3-1438691-6
																											3-1438691-5
																											3-1438691-4
																											3-1438691-3
																											3-1438691-2
																											3-1438691-1
																											3-1438691-0
																											2-1438691-9
																											2-1438691-8
																											2-1438691-7
																											2-1438691-6
																											2-1438691-5
																											2-1438691-4
																											2-1438691-3
																											2-1438691-2
																											2-1438691-1
																											2-1438691-0
																											1-1438691-9
																											1-1438691-8
																											1-1438691-7
																											1-1438691-6
																											1-1438691-5
																											1-1438691-4
																											1-1438691-3
																											1-1438691-2
																											1-1438691-1
																											1-1438691-0
																											ASSEMBLY PART NUMBER

CAVITIES WITH A NUMERIC SYMBOL INDICATES CLOSED TERMINAL LOCATIONS
 BLANK CAVITIES INDICATES OPEN TERMINAL HOLE LOCATIONS
 TERMINAL HOLE POSITION

PIN-OUT CHART

THIS DRAWING IS A CONTROLLED DOCUMENT.		OWN: B. CRISAMORE 21 JUL 2004	 TE Connectivity ASSEMBLY, 50-WAY, KEY A, PCM HARNESS
DIMENSIONS: mm		CHK: M. HITCHCOCK 21 JUL 2004	
TOLERANCES UNLESS OTHERWISE SPECIFIED: 0 PLC ±.3 1 PLC ±0.10 2 PLC ±.15 3 PLC ±.20 4 PLC ±.25 ANGLES FINISH ±.1		APP'D: C. MARTIN 21 JUL 2004	NAME: PRODUCT SPEC
MATERIAL: -		WEIGHT: -	APPLICATION SPEC: -
FINISH: -		SCALE: 2:1	RESTRICTED TO: -
Customer Drawing		SIZE: A100779	Customer Drawing
		SHEET 3 OF 4	REV: A16

